

ENGINE PARTS and ACCESSORIES

Continental Engines

REAL GASKET APPLICATIONS



LYCOMING

RG-75906: O-235; O-290; O-, IO-, -LIO-320; O-340; O-360-A, -B, -C, -D; IO-360-B; HO-360-A, -B; HIO-360-B; VO-, IVO-360; O-540-A, -B, -E, -F, -G; IO-540-C, -D, -J, -N, -R

RG-67193: IO-360-A, -C, -D; AIO-360-A, -B; HO-360-A, -C, -D; TIO-360-A; LIO-360-C1E6; VO-, GO-, TVO-435; GO-480; IO-, VO-, TVIO-540; IO-720

RG-71450: IO-540-B, -E, -M; TIO-540-A; IGO-540-B; IGSO-540-B; TIO-541-A

PC 210

CONTINENTAL

RG-530162: A-65; C-75, -85, -90, -145, -175; O-200; O-300

RG-532451: E-185; E-225; IO-346; O-470-A, -E, -J; IO-470-J, -K

RG-534857: O-470 except -A, -E, -J; IO-, TSIO-470; IO-, TSIO-520

RG-632310: IO-, TIO-, TSIO-360

RG-632459: GTSIO-520; TSIO-520-BE

PC 205

FRANKLIN

RG-17727: 4A-235; 6A-335; 6A4-150; 6A4-165, -200; 6A-335

PC 205



Blo-Proof Spiral Wound Gaskets



These special gaskets are V-shaped spirals wound with layers of stainless steel.

For Continental Engines:

A-65; C-85; C-90; O-200; O-300; GO-300; E-185; E-225; O-470-A, -E, -J; IO-470-J, -K

Part Number **PC 201**.. AEC627429

For all Continental O-470 and IO-470 Series

Engines:

...TSIO-470-B; TSIO-520-B, -C; ...GTSIO-520-C, -D (excluding O-470-...A, -E, -J and IO-470-J, -K)

Part Number **PC 201**.. 652458

For Lycoming Engines:

IO-540; IO-540-B, -E, -M, -WD; IGO-540-B; IGSO-540-B; TIO-540, -541 and TGIO-541

Part Number **PC 210**.. LW15486

For all remaining Lycoming Engines:

Part Number **PC 210**.. 77611

(Alternate Part Numbers-65321 and 75118)

Carburetor Induction Manifolds



For A-65, C-75, C-85, C-90

Part Number.....U35145

For O-200

Part NumberU35145-A1

PC 201

Continental Engine Mount Bushings used on all C & A series Continental engines 8 required per installation (priced each)

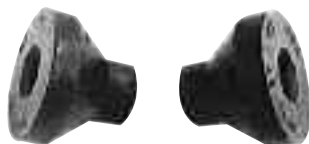

Part Number **PC 201** 22387

Continental Engine Mounting Components for C-90-14F and O-200

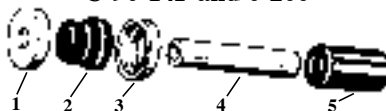

Item	Description	Part No.	Qty Req'd.
1.	Washer	530741	8
2.	Bushing	530740	8
3.	Seat	530626	8
4.	Spacer	653695	4
5.	Hose	628555-16	4

PC 201

Commonly Requested Continental Parts for C-Series and O-200 Engines

Cylinder base seals

A 65-75, C75-85-90, O-200.

Part Number 21477

Intake Gaskets: A 65-75

Part Number649976

Intake Gaskets: C75-85-90, O-200

Part Number (22250)649975

Crankshaft Seal: flanged shaft

A-65-75, C75-85-900, O-200

Part Number530019

Crankshaft Seal: Tapered Shaft

A-65-75, C75-85

Part Number24321

Tach Seal: A 65-75, C75-85-90-0200

Part NumberSA642714

Oil Sump Gasket: A65-75, C75-85-90-0200

Part Number652248

Rocker Cover Gasket: A65-75, C75-85-

90-0200 (653728).....655706

PC 201

**Celebrating Over 63 Years of Service to General Aviation!
Contact Us for the parts you need at:**

1-888-433-5433

ENGINE PARTS and ACCESSORIES

Commonly Requested Continental C-Series and 0-200 Parts (continued)

Carb to Intake Gasket A65 thru C-90 & 0-200 Part Number (21051)	652105
Carb to Airbox Gasket A65 thru C-90 & 0-200 Part Number (21323)	649974
Intake Hose Small A65 thru C-90 & 0-200 Part Number	21185
Intake Hose Large A65 thru C-90 & 0-200 Part Number	22800
Pushrod Housing Gasket: A65 thru C-90 & 0-200 (not used of -8 and -8f) Part No.....	530928
Connector Pushrod Housing A65-75, C75-85-90, & 0-200 Part Number	539840

PC 201

Gasket Oil Screen A65-75, C75-85-90, 0-200. Part Number	PC 590 MS35769-48
Gasket Oil Screen Housing Plug: A65-75, C75-85-90, 0-200 Part Number	PC 590 MS35769-11

Surplus Continental Rocker Cover Gaskets



For Continental Engines: A-65, A-75, C-85, C-90, O-200, C-145, O-300, (old 3500).....530162S

Lycoming Engine Mount Bushings



On left, without "collar"60883
On right, with "collar", 150 & 160 h.p71032

PC 210

Engine Manuals Continental Engine Operators Handbooks (glove box size)



Description	Part No.
A and C Series, 4-cylinder.....	AC4WM
A and C Series, 6-cylinder.....	AC6WM
C Series, 6-cylinder.....	C6WM
O Series, 6-cylinder	CO6WM
IO-470-C.....	X30024

Service and Overhaul Manuals

Description	Part No.
A-65, A-75 Parts and Overhaul Manual....	X30008
"C" Series Maintenance and Overhaul Manual (C-75, C-85, C-90, O-200).....	X30010A
"C" Series Parts Manual (C-75, C-85, C-90, O-200).....	X30011A
C-125, C-145, O-300 Maintenance and Overhaul Manual	X30013
C-125, C-145, O-300 Parts Manual	X30014
IO-520 Overhaul Manual	X30039A
IO-520 Parts Manual (A, D, E, F, J, K, L) X30628A	
IO-520 Parts Manual (B, BA, BB,C,CB,M,MB).....	X30624A
O-470 Overhaul Manual.....	X30586A
O-470 Parts Manual	X30587A
IO-470 Overhaul Manual	X30588A
IO-470 Parts Manual.....	X30589A
IO-360 Overhaul Manual	X30594A
IO-360 Parts Manual.....	X30595A

PC 200

Franklin Engine Manuals

Description	Part No.
Service Parts List, 6A4-150-B3 and 6A4-145-A-3 (not illustrated).....	F150PM
Service Parts List, 6A4-165-B3/B31 (not illustrated).....	F165PM
Service Manual, 6A4-150-B3/B31 and 6A4-165-B3	FESM
Service Bulletins and Letters.....	FESB

PC 204

Engine Manuals (continued) Eisemann Magnetos Handbook

Eisemann LA Series Magneto Handbook and Instructions contains service and overhaul information, exploded views and parts listings.

Part Number **PC 255** E-LAHB

Lycoming Engine Manuals Operators Manuals

Description	Part No.
O-235-C, O-290-D/-D2 Series.....	60297-9
O-540, IO-540 and HIO-540 Series	60297-10
O-, HO-, IO-, AIO-, HIO-, LIO- and TIO-360 Series	60297-12
O-320, IO-320, AIO-320 and LIO-320 Series	60297-16
AEIO-320, 360, and 540 Series.....	60297-21
O-320 "76" Series.....	60297-22
O-360 "76" Series.....	60297-25
TO-360 "76" Series	60297-26

Overhaul Manuals



Description	Part No.
Integral Accessory Drive Models	60294-6
Direct Drive Models	60294-7
"76" Series Models.....	60294-9

Parts Manuals

O-145 and GO-145 Instructions and Parts Manual and Magneto Section	L145PM
O-290-D Series	PC102-1
O-320-A, -B, -D, -E, IO-320-B, -E, and LIO-320.....	PC103
O- and HO-360, IO-, HIO-, AIO- and TIO-360	PC106
O-320-A and O-320-E.....	PC203-1
O-320-B and O-320-D	PC203-2
O-235	PC302
O-360-A.....	PC306-1
O-360-B, -C, -F, LO and TO-360 Series..	PC306-2
IO-, AIO-360-A and -B Series	PC406-1
IO-360-C, -J1A6D, LIO-360-C, HIO-360-A, -B, -C, -D, -E, -F, TIO-360-A, AEIO-360-A1E, -B1G6 and -H1A Series	PC406-2

PC 209

TELEDYNE CONTINENTAL[®] AIRCRAFT ENGINE

service bulletin

M91-8
Supersedes M89-13

Technical Portions Are
FAA Approved

10 July 1991

SUBJECT: **RECOMMENDED OVERHAUL PERIODS FOR ALL TELEDYNE
CONTINENTAL MOTORS AIRCRAFT ENGINES.**

MODELS
AFFECTED: All

COMPLIANCE: Overhaul

Thousands of hours of operating experience indicate that Teledyne Continental Motors (TCM) aircraft engines, when operated within prescribed limitations, instructions and recommendations, can be operated between overhauls for the number of hours listed in the following table. The overhaul periods listed are recommendations only. They are predicated on the **use of genuine TCM parts**, compliance with all applicable Service Bulletins and ADs, as well as all required preventive maintenance, periodic inspections, manufacturer's specifications, and the determination by a qualified mechanic that the engine is operating normally and is airworthy. The accomplishment of cylinder leakage checks and spectrographic oil analysis may be helpful in making this determination. Any operation beyond these periods is at the operator's discretion and should be based on the inspecting mechanic's evaluation of engine condition and operating environment. Calendar time also affects this condition and should be taken into consideration.

Particular attention should be paid to throttle response, power, smoothness of operation, oil consumption, to the proper use and maintenance of oil and air filters, and adherence to the recommended oil change periods. Emphasis should also be placed on recommended fuel management. These recommended overhaul periods in no way alter TCM's warranty policies.

Strict adherence to the latest Major Overhaul 100% Replacement Parts Service Bulletin is required.

Overhaul periods may vary depending upon the quality of parts and workmanship incorporated into the overhaul of an engine. TCM is unable to provide specific guidelines concerning the effect **non-TCM supplied parts** have on the overhaul periods listed in the following table and makes no recommendation with respect to overhaul periods for engines which have been overhauled, repaired or modified in a manner inconsistent with the specifications, limits and instructions set forth in the latest applicable TCM overhaul manual, parts catalog and service bulletins.

© TELEDYNE INDUSTRIES, INC. 1991



TELEDYNE CONTINENTAL MOTORS
Aircraft Products
P.O. Box 90 • Mobile, Alabama 36601

ENGINE PARTS and ACCESSORIES

Service Bulletin Continued...

10 July 1991

M91-8

Engine Model	① Overhaul Period	Engine Model	① Overhaul Period	Engine Model	① Overhaul Period
A65, A75 Series	1800 hours	IO-346 Series	1500 hours	⑤ TSIO-520M, P, R	1600 hours
C75, C85, C90, O-200 Series	1800 hours	IO-360 Series	1500 hours	TSIO/LTSIO-520AE	2000 hours
C125, C145, O-300 Series	1800 hours	IO-360KB	2000 hours	TSIO-520-BE	2000 hours
GO-300 Series	1200 hours	TSIO/LTSIO-360EB, KB	1800 hours	GTSIO-520 Series	1200 hours
E165, E185, E225 Series	1500 hours	TSIO-360FB, GB, LB, MB	1800 hours	GTSIO-520L	1200 hours
W670 Series	1000 hours	TSIO-360 Series	1400 hours	② GTSIO-520L	1600 hours
O-470 Series	1500 hours	IO-520 Series	1700 hours	GTSIO-520M, N	1600 hours
④O-470-U	1500 hours	TSIO-520 Series	1400 hours	6-285 Series	1200 hours
O-470-U	2000 hours	TSIO-520UB, VB, WB, AF, CE	1600 hours	IO-520 Series	1700 hours
IO-470 Series	1500 hours	TSIO-520NB	1400 hours	TSIO-550	1600 hours
TSIO-470 Series	1400 hours	③TSIO-520NB	1600 hours	TSIOL-550	2000 hours
GIO-470A	1000 hours	TSIO-520M, P, R	1400 hours		

1. Excepted are engines employed in aerial dressing, dusting or spraying. For these engines, we recommend a maximum of 1200 hours TBO, or less at operators discretion.
2. Applies to new GTSIO-520L engines having S/N 604701 and subsequent and rebuilt engines having S/N 227809R and subsequent only. Engine may be made eligible for the extended TBO (1600 hours) by installing parts per latest Parts Catalog X30046A and applicable Service Bulletins.
3. Applies to new TSIO-520NB engines having serial numbers 521391 thru 521399, 521400, 521405, 521406, 521411, 521412, 521419 and subsequent and rebuilt TSIO-520 NB engines having serial numbers 234070, 234074 and subsequent only. Engines may be eligible for the extended TBO (1600) hours by installing parts per latest parts catalog X30580A and applicable Service Bulletins.
4. Applies to new and rebuilt O-470U Spec. 11, 12, 13, 14, 17 and 18.

Note... Extended TBO's are predicated on the use of steel cylinders only, not chrome.

O-470U engines other than those listed above may be made eligible for the TBO increase (2000 hours) by installing P/N 646267A2 or subsequent cylinder and valve assembly, P/N 648029 piston, P/N 649226 ring set, P/N 646277 filter in the exhaust position, P/N 643779 oil pump, P/N 643749 oil pump gasket, P/N 648923 oil filter and 2, each P/N 402129P003 studs (or Cessna supplied oil filter adapter and associated parts) and any subsequent part number of these parts. Piston pin P/N 539467 must be replaced (not reused). Crankshaft counterweight pin and plate configuration must conform to current parts catalog X30587A. A log book entry will be required and new Spec. No. stamped on engine data plate (Refer to Engine Spec. List below).

ORIGINAL SPEC. #	NEW SPEC. #
O-470U1	13
O-470U2	14
O-470U3	17
O-470U4	18
O-470U5	17
O-470U6	18

⑤ Applies to new and rebuilt TSIO-520 M Spec. 4, 6, 7 and 8; TSIO-520 P Spec. 5 and 6, and TSIO-520 R Spec. 7, 9, 10 and 11.

TSIO-520-M, P & R engines other than those listed above may be eligible for the TBO increase (1600 hours) by installing cylinder & valve assemblies P/N 64657A1 or subsequent, piston P/N 648044, ring set P/N 649227, valve lifters P/N 646277 in the exhaust position, throttle body P/N 649185A4, TCM (formerly Bendix) 646957 R.H. magneto, 646958 L.H. magneto, 636951 Harness, or EQ6583 pressurized magneto and harness kit, oil pump assembly P/N 643717-1, P/N 643749 oil pump gasket, and oil filter P/N 649923 (or Cessna supplied oil filter adapter and associated parts) or subsequent part number of these parts.

To install new oil pump remove one (1) each P/N 402159 and P/N 402157 stud. Replace stud P/N 401652 with stud P/N 402129P003 and install spacer P/N 646582-1.35 and P/N 646582-2.00 on existing studs after oil pump is installed. A log book entry will be required and new Spec. No. stamped on engine data plate (Refer to Engine Spec. List below).

ORIGINAL SPEC. #	NEW SPEC. #
TSIO-520P1	5
TSIO-520P2	6
TSIO-520P3	6
TSIO-520M1	6
TSIO-520M2	7
TSIO-520M3	7
TSIO-520R1	9
TSIO-520R3	10
TSIO-520R4	9
TSIO-520R5	10
TSIO-520R6	11

ENGINE PARTS and ACCESSORIES

Franklin Engine Parts, 150 and 165 hp.

Commonly Requested Items

<i>Description</i>	<i>Number Required</i>		<i>Part No.</i>
	<i>150</i>	<i>165</i>	
Bolt, Propeller	8	8	U17662
Gasket, Carburetor	1	—	10942
Gasket, Crankcase Cover (Real Gasket) ...	1	1	RG-18532
Gasket, Oil Pan	1	1	RG-10366
Gear, Magneto Shock Absorber (no. 1 thru 32083 engines)	24	16	10601
Gear, Magneto Shock Absorber (no. 32084 and up engines)	2	2	19313
Packing, Valve Lifter Rod Tube (cylinder end—small)	24	12	17864
Packing, Valve Lifter Rod Tube (crankcase end—large)	—	12	17794
Seal, Crankshaft Oil	1	1	17036

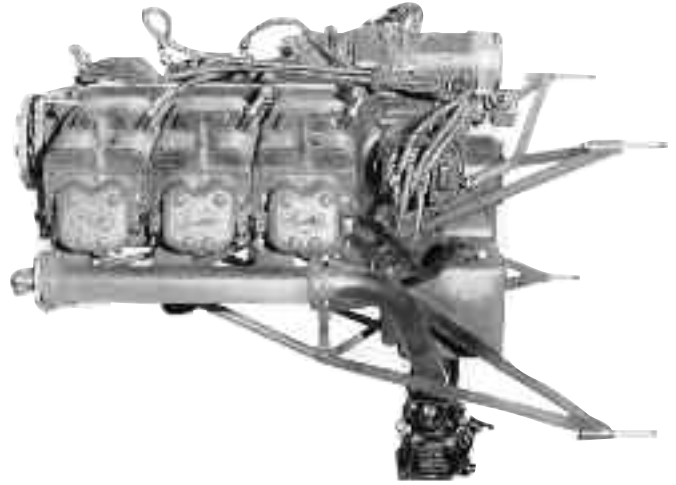

Major Overhaul Gasket Set

<i>Description</i>	<i>Part No.</i>
150 hp.	18045
165 hp.	18570

Note: Exhaust gasket NOT included in kit.

Gaskets Required for Top Overhaul

<i>Description</i>	<i>Number Required</i>		<i>Part No.</i>
	<i>150</i>	<i>165</i>	
Gasket, Inlet Manifold	6	6	17671
Gasket, Valve Cover	6	6	RG-17727
Ring, Cylinder Seal	6	6	17729
Packing, Lifter Rod Tube	24	12	17864
Packing, Lifter Rod Tube (Crankcase)	—	12	17794

Franklin Engine Manuals



<i>Description</i>	<i>Part Number</i>
Service Parts List, 6A4-150-B3 and 6A4-145-A-3 (not illustrated)	F150PM
Service Parts List, 6A4-165-B3/B31 (not illustrated)	F165PM
Service Manual, 6A4-150-B3/31 and 6A4-165-B3	FESM
Service Bulletins and Letters	FESB

Bushing Kits

<i>Description</i>	<i>Number Required</i>		<i>Part No.</i>
	<i>150</i>	<i>165</i>	
Crankshaft Bushing, Standard	1	1	19644
Crankshaft Bushing, .010 Undersize	1	1	19645
Connecting Rod Bushing, .010 Undersize	12	12	18020
Connecting Rod Bushing, .020 Undersize	12	12	18021

PC 204

TEXTRON Lycoming

Reciprocating Engine Division/
Subsidiary of Textron Inc.
652 Oliver Street
Williamsport, PA 17701 U.S.A.

SERVICE INSTRUCTION

DATE: July 1, 1992

Service Instruction No. 1009AJ
(Supersedes Service Letter No. L201C)
Engineering Aspects are
FAA Approved

SUBJECT: Recommended Time Between Overhaul Periods.

MODELS AFFECTED: All Textron Lycoming Piston Aircraft Engines.

The following chart shows the established time between overhaul (TBO) for Textron Lycoming piston aircraft engines. TBO's can be established on engines that incorporate GENUINE TEXTRON LYCOMING PARTS only, and are not applicable if the engine contains parts other than those supplied by Textron Lycoming. Service experience, variations in operating conditions, and frequency of operation are some of the factors taken into consideration when a TBO is established. Because of variations in the manner in which engines are operated and maintained, Textron Lycoming can give no assurance that any individual operator will achieve the recommended TBO.

Continuous service assumes that the aircraft will not be out of service for any extended period of time. Refer to latest revision of Service Letter No. L180 if the aircraft is to be out of service for a period of time greater than 30 days.

Because of engine deterioration in the form of corrosion (rust), drying out and hardening of composition materials such as gaskets, seals, flexible hoses, fuel pump diaphragms and abnormal wear during starting on soft metal bearing surfaces due to the loss of a protective oil film during extended periods of inactivity, all engines that do not accumulate the recommended operating hours between overhaul in a twelve (12) year period must be overhauled during the twelfth year.

Although the TBO's shown in the Table on page 2

represent Textron Lycoming's recommendations, owners of some Textron Lycoming piston engines may decide to continue to operate the engine beyond the hours stated, unless otherwise limited by government regulations. It is the responsibility of the party maintaining the engine to decide if it is feasible to operate the engine beyond the recommended number of hours. This decision should be based on knowledge of the engine and the conditions under which it has been operated.

Engine accessories and propellers may require overhaul prior to engine overhaul. This decision, too, is to be made by the party responsible for maintaining the engine or by the accessory manufacturer.

The TBO's in the chart do not apply to engines engaged in crop dusting or other chemical-application flying. These engines should be overhauled at 1500-hour intervals or at recommended TBO, whichever is lower.

Reliability and average service life cannot be predicted when an engine has undergone any modification not approved by Textron Lycoming. The TBO's shown in the table are recommendations for engines as manufactured, without considering any modifications that may alter the life of the engine. The TBO's in no way affect, change, or alter Textron Lycoming's current published warranty policy.



General Aviation
Manufacturers Association

Page 1 of 3

ENGINE PARTS and ACCESSORIES

RECOMMENDED TIME BETWEEN OVERHAUL PERIODS

FIXED WING AIRCRAFT					
Engine Models	See Note	Hours	Engine Models	See Note	Hours
O-235 Series (except -F, -G, -J)	12	2400	IO-540-E, -G, -P	1,10,11	1500
O-235-F, -G, -J	13	2000	IO-540-S, -AA, -AB	2,10	1500
O-290-D	-----	2000	IO-540-J, -R	2,10	1500
O-290-D2	-----	1500	IO-540-K, -L, -M	10	2000
O-320 Series (except O-320-H);			IO-540-K1B5, -K1G5	10,11	2000
IO-320-A, -E	1,10	2000	AEIO-540 Series	6,10	1400
O-320-H	10	2000	IGO & IGSO-540 Series	-----	1200
IO-320-B, -D, -F	4,6,10	2000	TIO-540-V, -W, -AE	3,4,11	2000
IO-320-C	2,4,10	1800	TIO-540-C, -AA, -AB, -AF	3,4,7,11	2000
AIO-320 (160 hp)	6,10	1500	TIO-540-A, -F, -J, -N, -R, -S, -U	3,4,11,14	1800
AEIO-320 Series	6,10	1500	TIO-541-A (310 hp)	3	1300
O-340 Series	1	2000	TIO-541-E (380 hp)	3,9	1500
O-360 Series (except O-360-E);			TIGO-541 (425 hp)	3	1200
IO-360-B, -E, -F (180 hp)	1,4,10	2000	IO-720 Series	10,11	1800
O-360-E	4,10	2000			
IO-360-A, -C, -D, -J (200 hp)	4,5,6,10	2000			
TO-360-C, -F; TIO-360-C	3	1800			
TO-360-E (180 hp)	3,4	1800			
AIO-360 (200 hp)	6,10	1400			
TIO-360-A Series	3	1200			
AEIO-360 Series (180 hp)	6,10	1500			
AEIO-360 Series (200 hp)	6,10	1400			
O-435; GO-435	-----	1200			
GO, GSO-480; IGSO-480	1	1400			
O-540-A, -B, -E4A5, -F;					
IO-540-C, -D	1,10	2000			
O-540-E4B5, -E4C5	1,10,11	2000			
O-540-G, -H, -J; IO-540-N,					
-T, -V, -W	10	2000			
O-540-L3C5D	2,10	2000			
IO-540-A, -B (290 hp)	1,10,11	1400			

ROTARY WING AIRCRAFT		
O-320-A2C, -B2C	-----	2000
O-360-C2B, -C2D; HO-360;		
HIO-360-B	-----	1500
HIO-360-A, -C, -D, -E, -F Series	-----	1500
VO-360-A Series	-----	600
VO-360-B; IVO-360	-----	1000
VO-435-A Series	-----	1200
VO-435-B Series	-----	1200
TVO-435 Series	3	1000
VO-540 Series	8	1200
IVO-540 Series	-----	600
TVO, TIVO-540 Series	3,8	1200

NOTES

1. Only engines built with 1/2 inch dia. exhaust valve stems. Engines of this series with 7/16 inch dia. exhaust valves should not exceed 1200 hours between overhauls regardless of the type of operation. New and remanufactured engines built with 1/2 inch dia. exhaust valve stems are identified, respectively, by serial number and date in the latest edition of Service Instruction No. 1136.

2. These engines are designed to incorporate exhaust

turbocharging.

3. Turbochargers may require removal, prior to engine overhaul, for carbon removal and repair.

4. Engines with reverse rotation have same overhaul times as corresponding normal rotation models.

5. 1200 HOURS: Engines that do not have large main bearing dowels should not be operated more than 1200 hours between overhauls.

ENGINE PARTS and ACCESSORIES

Service Instruction No. 1009AJ

1400 HOURS: Engines that have large main bearing dowels may be operated to 1400 hours between overhauls. These include engines with serial numbers L-700-51A and up, and L-101-67A and up; engines which are in compliance with the latest edition of Service Bulletin No. 326; and remanufactured engines shipped after January 26, 1970.

2000 HOURS: Engines that have large main bearing dowels and redesigned camshafts may be operated to 2000 hours between overhauls. These include engines with serial numbers L-9762-51A and up; IO-360-C1E6 engines with serial numbers L-9723-51A and up; LIO-360-C1E6 engines with serial numbers L-524-67A and up; engines that are in compliance with the latest edition of Service Bulletin No. 326 and Service Instruction No. 1263. Remanufactured engines shipped after October 1, 1972 may be operated to 2000 hours between overhauls except those with serial numbers L-2349-51A and L-7852-51A which do not have the redesigned camshaft and must not exceed 1400 hours operating time between overhauls.

6. The reliability and service life of engines can be detrimentally affected if they are repeatedly operated at alternating high and low power applications which cause extreme changes in cylinder temperatures. Flight maneuvers which cause engine overspeed also contribute to abnormal wear characteristics that tend to shorten engine life. These factors must be considered to establish TBO of aerobatic engines; therefore it is the responsibility of the operator to determine the percentage of time the engine is used for aerobatics and establish his own TBO. The maximum recommended is the time specified in this instruction.

7. TIO-540-C series engines with serial numbers L-1754-61 and up, TIO-540-C series engines that were remanufactured or overhauled at Textron Lycoming, Williamsport, PA after March 1, 1971 and TIO-540-C series engines that have been modified to incorporate large main bearing dowels as described in the latest revision of Service Instruction No. 1225 may be operated to 2000 hours. Engines that do not incorporate this modification must not exceed 1500 hours between overhauls.

8. VO, TVO and TIVO-540 engines built with P/N

77450 connecting rods as described in the latest edition of Service Bulletin No. 371 may be continued in service to 1200 hours. Engines that do not incorporate this new connecting rod are restricted to 1000 hours for VO-540 models and 900 hours for TVO and TIVO-540. See latest edition of Service Bulletin No. 371 for improved connecting rod assembly.

9. TIO-541-E series engines with serial numbers L-804-59 and up, remanufactured engines shipped after March 1, 1976 and all engines that incorporate the improved crankcases and cylinder assemblies described in the latest revision to Service Bulletin Nos. 334 and 353 may be operated for 1600 hours before overhaul. Engines not in compliance with these requirements are limited to 1200 hours recommended time between overhaul.

10. Some engines in the field have been altered to incorporate an inverted oil system in order to perform aerobatic maneuvers. Whenever this modification is done to an engine, the TBO of the engine must be determined in the same manner listed for AEIO engines of the same model series.

11. If an engine is being used in "scheduled frequent" type service but not for flight training, and accumulates 60 hours or more per month, and has been so operated consistently, add 200 hours to TBO time.

12. To qualify for the 2400 hour TBO, high-compression O-235's must have the increased strength pistons (P/N LW-18729). See latest issue of Service Letter L213.

13. The high-compression O-235-F, -G, and -J series do not have the increased strength pistons (P/N LW-18729); therefore, they do not qualify for the 2400-hour TBO.

14. TIO-540-A series engines with serial numbers L-1880-61 and up, TIO-540-A series engines that were remanufactured or overhauled at Textron Lycoming, Williamsport, PA after March 1, 1971 and TIO-540-A series engines that have been modified to incorporate large main bearing dowels as described in the latest revision of Service Instruction No. 1225 may be operated to 1800 hours. Engines that do not incorporate this modification must not exceed 1500 hours between overhauls.

Page 3 of 3

ENGINE PARTS and ACCESSORIES

Brackett Air Filters

Brackett filters are FAA/PMA approved—and STC-SA71GL, STC-SA693CE, and STC-SA12CE Approved.

Polyurethane as the filtering media combined with Brackett's patented "Wetting Agent" will give your engine protection from dust and dirt to prolong engine life and cut maintenance. The Brackett polyurethane aircraft element can be changed without replacing the complete air filter assembly.

Now, induction systems, cylinders, and combustion chambers can be kept almost totally free of harmful contaminants with correct fitting of Brackett aviation air filters.



BRACKETT AIR FILTER APPLICATION CHART

Manufacturers' Aircraft Models	Brackett Filter Assy. No.	Filter Gasket Part No.	Brackett Element Number
Aero Commander			
A-9, A9A, A9B	BA-104		BA-3
100, 100A	BA-8910	BA-8910-02	BA-8905
100, 180	BA-3910		BA-3905
112, 112A, 112B	BA-3910		BA-3905
112TC, 112TC-A, 114, 114A	BA-4010		BA-4005
500	BA-152		BA-152E
500A, -B, 560F, 680F, 680FL	BA-151		BA-151E
680FLP, 500U	BA-151		BA-151E
580, 580A, 560E, 680	BA-2610L/R		BA-2605L/R
Aircoupe			
415C, -CD, -D, -E, -G	BA-8810		BA-8805
F-1, A-1, A2-A	BA-4106	BA-4101	BA-4108
Beech			
23, A23, A23A, A23-19, A23-19A, A23-24, B23	BA-104		BA-3
C-23, C-24R, A24R, B24R, B19, C-23A	BA-7510	BA-7504	BA-7305
33, A33, B33, C33, E33, F33	BA-7110	BA-7104	BA-7112
C33A, E33A, E33C, F33A, F33C, G33B	BA-7210	BA-7206	BA-7112
35, A35, B35 thru SN D2605	BA-7310	BA7303	BA-7305
B35, C35, D35, E35, F35, G35, H35,			
J35, K35, M35, N35, P35, 35R	BA-7110	BA-7104	BA-7112
S35 thru SN D7671	BA-7410	BA-7406	BA-7112
S35, V35, V35A, V35B, 36, A36,			
A36TC, B36TC, A45 (T-34), B45 (T-34A),			
D45 (T-34B), W/STC SA1450SW	BA-7210	BA-7206	BA-7112
50, B50, C50, D50, D50A,			
D50B, D50C, D50E	BA-4610		BA-4805
55, A55, B55	BA-7610	BA-7603	BA-7605
C55 SN TE1-451, D55, SN TE452-767,			
E55, SN TE788-1078, 58 thru SN TH740	BA-6210-1		BA-6205
E55, E55A, SN TE1079 and up	BA-7710	BA-7703	BA-7705
58, 58A, SN TH741 and up	BA-7710	BA-7703	BA-7705
A65, 70, 65-B80, -B88	BA-100	BA-1003	BA-7
76	BA-7010	BA-7010-03	BA-7005
77	BA-2010	BA-2002	BA-6108
95, B95, B95A, D95A	BA-7810		BA-7805
Bell			
47G-2, -2A, -3, 47G-2A1, 47J, 47J2,			
47J-2A, 47G-3B, -3B1, -3B2, -3B2A	BA-102		BA-2
47G-4A, 47G-4, 47G-5, 47J-2, 47J-2A,			
47G-3B, 47G-3B1, 47G-3B2	BA-103		BA-9
Bellanca			
14-19-3A	BA-8110	BA-8101	BA-8103-1
17-30	BA-8110		BA-3
17-31	BA-104		BA-3
17-30A	BA-8110		BA-3
300	BA-104		BA-3
Brantly			
B-2, B-2B	BA-104		BA-3
Britten Norman			
BN-2A-5 with Lycoming O-540-E4C5 engines, BN-2, -2A, -2A-2, -2A-3, -2A-8, -2A-9, -2A-20, -2A-21, -2A-27, -2B-20, -2B-21, -2B-26, -2B-27	BA-104		BA-3
Cessna			
120, 140, 140A, 150, 150A, -B, -C, -D, -E, -F, -G, -H, -J, -K, -L, -M, A150M, 152, A152	BA-4106	BA-4101	BA-4108
170, 170A, -B, 172, 172A, -B, -C, -D, -E, -F, -G, -H, -I, -K, -L, -M			
	BA-5110		BA-6108
172-N, -P	BA-5110A	BA-5103	BA-6108

Manufacturers' Aircraft Models	Brackett Filter Assy. No.	Filter Gasket Part No.	Brackett Element Number
Cessna (continued)			
R172K	BA-111		BA-24
172RG	BA-5810	BA-5803	BA-5805
175, 175-A, -B, -C	BA-101	BA-1102	BA-8
177, 177A, -B, RG, F177RG	BA-5710	BA-5703	BA-5705
180 (1953-1955)	BA-8010	BA-8002	BA-8005
180A, -B, -C, -D, -E, -F, -G, -H, -J, -K	BA-8110	BA-8101	BA-8103-1
182, 182A, -B, -C, -D, -E, -F, -G, -H, -J, -K, -L, -M, -N, -P, -Q, -R	BA-8110	BA-8101	BA-8103-1
R-182, TR-182, T-182	BA-2510	BA-2503	BA-2505
185, 185A, -B, -C, -D, -E, A185E, A185F	BA-8110	BA-8101	BA-8103-1
188, 188A		BA-114	BA-14A
190, 195, 195-A, -B	BA-8410		BA-8405
205, 205-A	BA-2110	BA-2103	BA-2305
P206, -A, -B, -C, -D, -E, U206, -A, -B, -C, -D, -E, -F, -G	BA-2210L	BA-2206	BA-2205L
TP206A, -B, -C, -D, -E,			
TU206A, -B, -C, -D, -E, -F, -G	BA-2410		BA-2405
207, 207A	BA-2210L	BA-2206	BA-2205L
T207, T207A	BA-2410		BA-2405
210, 210A, -B, -C	BA-2110	BA-2103	BA-2305
210D, -E, -F, -G, -H, -J, -K, -L, -M, -N (to SN 64135 without AIR)	BA-2210L	BA-2206	BA-2205L
	BA-2210R	BA-2206	BA-2205R
210N (SN 64135 and up or with AIR), 210R	BA-2410		BA-2405
P210, all	BA-8710	BA-8703	BA-8705
T-210F, -G, -H, -J, -K, -L, -M, -N, -R	BA-2410		BA-2405
T-303	BA-5210	BA-2503	BA-5205
310, -A, -B	BA-2110	BA-2103	BA-2305
310F, -G, -H, -I, -J, -K, -L	BA-2310	BA-2303	BA-2305
310N, -P, -Q, T310P, T310Q	BA-107		BA-12
310R	BA-117		BA-17
T310R	BA-108		BA-13
337, -A thru -H	BA-111		BA-24
P337, T337, front engine	pending		
P337, T337, rear engine	pending		
340, 340A	BA-109		BA-22
401, 401A, 401B to SN 300	BA-107		BA-12
402, 402A, 402B to SN 800	BA-107		BA-12
402B, SN 801 and up	BA-108		BA-13
402C	BA-109		BA-22
404	BA-130		BA-30
411, 411A	BA-3810		BA-3805
414, 414A	BA-109		BA-22
421, 421A, -B, -C	BA-108		BA-13
L-19	BA-101	BA-1102	BA-8
T-50, AT-17, UC-78, JRC-1	BA-2710		BA-2705
Champion			
8KCAB, 8GCBC, 7KCAB, 7GCBC, 7GCAA	BA-8110	BA-8101	BA-8103-1
7GCAA, 7GCBC	BA-105		BA-11
7KCAB, 8KCAB, 7ECA	BA-106		BA-11
7GC, 7GCA, 7GCBC	BA-104		BA-3
7HC, 7KC	BA-104		BA-3
7ECA with Continental O-200A engine,			
7ACA, 7ECA, 7FC, 65CA	BA-4106	BA-4101	BA-4108
Christen			
A-1	BA-4105-1		BA-4108
DeHavilland			
DHC-2 (L-20)	BA-8210-1	BA-8208	BA-8205

(Chart is continued on next page.)

ENGINE PARTS and ACCESSORIES

BRACKETT AIR FILTER APPLICATION CHART (continued)

Manufacturers' Aircraft Models	Brackett Filter Assy. No.	Filter Gasket Part No.	Brackett Element Number
Eagle Duster			
all models	150017-1		BA-129-1
Great Lakes			
2T1A-2	BA-101	BA-1102	BA-8
Grumman American			
AA-1, -1A, -1B, -1C, -5	BA-4210	BA-4101	BA-4108
AA5A	NR		BA-19
AA5B Tiger, GA-7	BA-120		BA-20
Agcat G164, G164A	BA-8210	BA-8101	BA-8205
G164B	BA-105		BA-10
Hiller			
UH-12, UH-12A, -B, -C, -D, -E	BA-102		BA-2
Helio			
H295	NR		BA-21
Hughes			
269A, -A-1, -B, -C	BA-102		BA-2
Lake			
LA4, LA4-200	BA-3110	BA-3103	BA-7305
Luscombe			
8, 8A thru 8F, T8F	BA-4106	BA-4101	BA-4108
Maule			
M-4-210, M-4-210C	BA-111		BA-24
M-4-210S, -210T, M-5-210C, MA-4,			
M-4C, -4S, -4T, -4-220, -4-220C, -4-220S,			
-4-220T, -4-180C, -4-180S, -4-180T,			
M-5-220C, -235C, -180C, -210TC,			
M-6-180, -235, MX7-180, M-7-235	BA-6110	BA-5103	BA-6108
Mooney			
M-10	BA-4106	BA-4101	BA-4108
M-18C	BA-5110	BA-5103	BA-6108
M20, M20A, -B, -C, -D, -G	BA-6110	BA-5103	BA-6108
M20E, -F	BA-6310		BA-6305
M20J	BA-6210	BA-6203	BA-6205
Navion			
G, H	BA-4310	BA-4303	BA-4305
A	BA-113		BA-25
B	BA-116		BA-26
North American			
AT6 (SNJ)	BA-8310		BA-8305
Partenavia			
P65, P68B, P68C	pending		
Piper			
600, 601	NR		BA-4
J-3, J-4, J-5	BA-4106	BA-4101	BA-4108
PA-11, -11S, -12, -12S	BA-4106	BA-4101	BA-4108
PA-16, -17, -18, -19	BA-4106	BA-4101	BA-4108
PA-18-150, PA-18A-150, PA-18S-150,			
SN6964 and up, with item 110 installed	BA-112		BA-13
PA-20, 115 and 135 hp.	BA-4106	BA-4101	BA-4108
PA-22, all	BA-4106	BA-4101	BA-4108
PA-23, 150 and 160 hp.	BA-3110A		BA-7305
PA-23, 235 and 250 hp.	BA-104		BA-3
PA-23-250, PA-E23-260 SN 27-2505 and up	BA-115		BA-15
PA-23-250, PA-E23-250			
with turbo Lycoming engine	BA-3510	BA-3510-06	BA-3505

Manufacturers' Aircraft Models	Brackett Filter Assy. No.	Filter Gasket Part No.	Brackett Element Number
Piper (continued)			
PA-23-250 with A/R			
research turbo	pending		
PA-24-180 up to SN 1476	BA-3110A		BA-7305
PA-24-250 up to SN 1476	BA-3210		BA-3205
PA-24, 180 and 250 hp. SN 1477 and up,			
PA-24-250 SN 103-1476 with Piper			
kit 754-285 installed, PA-24-260			
SN 4000-4802 except 4783	BA-104		BA-3
PA-24-280C	BA-4510	BA-4502	BA-4505
PA-25, 235 and 260 hp.	BA-104		BA-3
PA-28-140, -150, -160,			
-180, -235	BA-104		BA-3
PA-28-181, -201T	BA-104		BA-3
PA-28R-201T	BA-104		BA-3
PA-28RT-201T	BA-104		BA-3
PA-28R-201, PA-28RT-201,			
PA-28R-180, PA-28R-200	BA-105		BA-10
PA-28-151, -161	NR		BA-16
PA-28-236 SN 7911283 and up	BA-2910	BA-2910-06	BA-2905
PA-28 SN 7011001-7911283			
with modification kit 763928V	BA-2910	BA-2910-06	BA-2905
PA-30-160	BA-105		BA-10
PA-30 with Ray Jay turbo	pending		
PA-31, PA-31 300 to 350 hp.	BA-100	BA-1003	BA-7
PA-31P, PA-31P-350	BA-3310	BA-3310-03	BA-3305
PA-32-260	BA-104		BA-3
PA-32-300 SN 76-64001 and up, PA-32-301,			
PA-32R-300, PA-32RT-300, PA-32R-301	BA-104		BA-3
PA-32-300 with IO-540-K1A5	BA-115		BA-15
PA-32RT-300T	BA-100	BA-1003	BA-7
PA-32-301T, PA-32R-301T	BA-3010	BA-3010-02	BA-7
PA-34-200T, -220T	BA-104		BA-3
PA-34-200 with Lycoming IO-360-C01E6			
or LIO-360-C1E6	BA-105		BA-10
PA-36-300 with Continental			
6-285-B, PA-36-375	BA-104		BA-3
PA-38	BA-4106	BA-4101	BA-4108
PA-39	BA-105		BA-10
PA-39 with Ray Jay turbo	pending		
PA-44	BA-105		BA-10
PA-44-180T	BA-3510	BA-3510-06	BA-3505
Robinson			
R-22	BA-110		BA-23
Stearman			
all series 75	BA-118		BA-18
Stinson			
108, 108-1, -2, -3	BA-9110		BA-9105
Swift			
GC-1A, GC-1B	BA-4106	BA-4101	BA-4108
GC-1B with Lycoming O-320			
or Continental O-300	BA-5110	BA-5103	BA-6108
Taylorcraft , all models	BA-4106	BA-4101	BA-4108
Varga			
2150A	BA-4106	BA-4101	BA-4108

Reasons to Choose a Brackett Filter

- FAA/PMA approved—83 different models
- Our patented treated foam has a 98 percent efficiency rating.
- You replace only the low-cost, throw-away element.
- Easy, accurate servicing by replacement at specified times
- Readily available to all F.B.O.s distributed by most major aircraft supply houses.
- Dual-stage foam element increases dust holding capacity.
- It's a proven filter. Brackett air filters have been in service on aircraft and helicopters since 1968. At present, Brackett foam filters are installed as factory original equipment on eleven current production aircraft and one helicopter.
- Brackett's foam filter is unaffected by water (approved for sea planes). It has no pleats to store dirt and is abrasive resistant.
- Brackett foam filters have exclusive filter frame safety features.

NOTE:

Our STCs require the elements to be replaced every 12 months, regardless of the flying time, or more often as per service instructions.

Don't Neglect Your Air Filter!

Check the entire intake system for leaks. Here is a quote from a Lycoming engine flyer:

"Dust or some form of dirt is frequently the principle factor in premature piston ring and cylinder wear. If a worn or poorly fitting air filter allows as much as a tablespoon of abrasive material into the cylinders, it will cause wear to the extent that an overhaul will be required."

All items on this page are Price Code 275 unless otherwise noted

Price and availability subject to change without notice. Univair's Toll Free Sales: 1-888-433-5433

ENGINE PARTS and ACCESSORIES

Air Filters — Air Maze Original Paper Type

**UNIVAIR can now supply a wide variety of air filters for light planes.
Protect yourself and your engine by replacing your air filter regularly.**

For Continental C-75, C-85, Ercoupe



Part Number **PC 120**415-40585-1

For Continental A-65, A-75, C-85, C-90, and C-125; Luscombe 8A thru 8F, Taylorcraft, Cessna 140, Swift GC-1A and GC-1B, etc.

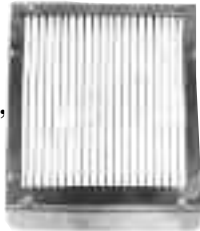

Part Number (40599)..PC275..... 600314
Stud.....24306
Cross Pin (Old 24308).....652021
Gasket.....652142
Fastener on box (531050).....**PC 599**..99871C098

PC 201

For Franklin 150-165 and Stinson 108 series



Part Number **PC 180**108-6221805

If you can't find the part you need, give us a call. We're here to help you with all of your classic aircraft needs.

**Info: 1 (303) 375-8882
e-mail: info@univair.com
website: www.univair.com**

For Aeronca 7AC and 11AC



Part Number **PC 102** U2-849

For O-320 Lycoming Engine in Piper Apache

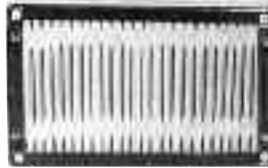

Part Number (120120) **PC 150** 17775-000

Piper Aircraft Filters

For J-3 thru J-5, PA-11, PA-15, PA-17, PA-18 (90 hp., 105 hp, 125 hp. models) and PA-22 (125 hp. models)



Part Number (40599)..... **PC 275** 600314

For PA-18 and PA-18A (150 hp. models) SN 18-6964 & up



Part No..... **PC 150** ..U454-118

For PA-18 (135 hp. and 150 hp. models)



Part Number (460-638)..... **PC 275**120086

For PA-22 (108 hp., 135 hp., 150 hp. and 160 hp.)



Part Number (13681)..... **PC 275**121494

Carburetor Air Intake Box for 145 Swift, 170 Cessna



Part Number **PC 201** 530852

FAA/PMA Approved Carburetor Air Boxes for 4 Cylinder Continental Engines

For Continental A-65, C-75, 85 & 90



For C75-8, C75-8F, C75-12, C75-12F, C85-8, C85-8F, C85-12, C85-12F, C90-8F, C90-12F Engines
.....UA50256

For A65-1, A65-3, A65-6, A65-7, A65-8, A65-8F, A65-9, A65-9F, A65-12, A65-12F, A65-14, A65-14F Engines
.....UA50495

PC 201

**Carburetor Air Intake Box and Filter
FAA/PMA Approved**

Complete Assembly for the Aeronca



7AC-11AC (includes Air Filter)U4-601-1
Filter onlyU2-849

PC 102

ENGINE PARTS and ACCESSORIES

Precision Carburetor's (formerly Marvel-Schebler)



UNIVAIR has hundreds of
Precision (formerly Marvel-Schebler)
carburetor parts in stock; call us at (303) 375-8882 with
your specific requirements.

CARBURETOR REFERENCE INFORMATION

ENG. MFG. PART NO.	CARBURETOR	ENG. MODEL MODEL	PRECISION PART NO.
CONTINENTAL			
626789	MA-4-5	GO-300-A-, A1, -C-, C6-, D-, D2-, D6	10-4171
627365	MA-3PA	A65-8, A75	10-4233
627366	MA-3SPA	C75-8, 12-, C85-12	10-4240-1
637101	MA-3SPA	SUP BY 10-4252-12	10-4252-1
627367	MA-3SPA	C90-8F, 12F, 14F, 16F	10-4252-2
629175	MA-3SPA	C90-12, 18, 28	10-4457-1
641139	MA-4-5	0-470-K, L, R, S	10-4893-1
633028	MA-3SPA	0-200 A, B	10-4894-1
633029	MA-3SPA	O-300-A, C, D, C-145	10-4895-1
637835	MA-3SPA	C90-16F, 8F, 12F, 14F	10-5082
LYCOMING			
61547	MA-3A	0-235-C1, C1B, C2A, C2B, C2C, H2C, L2C	10-3103-1
69250	MA-4SPA	0-320-A1A, A2A, A2B, A3A, B1A, B2A	10-3678-12
72394	MA-4SPA	0-320-A1B, A2A, A2B, A2C, A2D, A3B, A3C, B1B, B2B, B2C, B3B, B3C, D1A, D1AD, D1C, D2A, D2B, D2C, E1A, E2A, E2B, E2C, E3D, A2B	10-3678-32
72740	MA-4-5	0-540-A1A, A1A5, A1B5, A1C5, A1D, A1D5, A2B, A3D5, A4A5, A4B5, A4D5, B1A5, B1B5, B2A5, B2B5, B4B5, E1A5, E4A5, E4B5, E4C5, J1A5D, J1B5D	10-4404
74121	MA-4-5	0-540-B2C5, B2C5D, G1A5, G1A5D, G2A5, H1B5D, H2A5, H2B5D, A15D, B2B5	10-4404-1
77279	MA-4SPA	0-320-A2B, 0-320-B2B, 0-320-D2A, 0-320-E2A	10-4910
LW-16559	MA-4SPA	0-320	10-4910-1
77585	MA-3A	0-235-F1B, 0-235-C2C, 0-235-L2C	10-4953
77939	MA-3PA	0-235-G2A, 0-235-C2A, 0-235-L2C	10-4978-1
78728	MA-4SPA	0-320-A1B, D1F, D2F, E1C, E1F, E1J, E2D, E2F, E2G, E3H, H1AD, D2C, E1A, E2C, E3D, H2AD, A2B, B2B, E2A	10-5009
LW-10196	MA-4-5	0-540	10-5042
LW-10619	MA-3PA	0-235-E2A, C1, H2C, C2A, C2C	10-5050
LW-10540	MA-4-5	0-540-B2B5, B4B5, B4B5D, E4B5D, J2A5D, J3A5D, E4B5, J1A5D, OB-540-E4B5"	10-5054
LW-14016	MA-3PA	0-235-K2A, K2B, L2A, N2A, H2C, L2C	10-5142
LW-15380	MA-4-5	0-360-A4M, 0-360-A1A, 0-360A4A"	10-5193
LW-15986	MA-4SPA	0-320-D2G, D2H, D2J, E2H, H2AD, A2C, D1AD, E1J, E2D, E2G, E3H, D1A, D2A, E3D, E2A, D3G	10-5217

THIS CHART IS FOR REFERENCE ONLY. REFER TO THE AIRCRAFT EQUIPMENT LIST OR CONTACT THE ENGINE MANUFACTURERS FOR SPECIFIC APPLICATION INFORMATION.

All items on this page are Price Code 260 unless otherwise noted

Price and availability subject to change without notice. Univair's Toll Free Sales: 1-888-433-5433

ENGINE PARTS and ACCESSORIES

Precision Carburetor Parts

Carburetor Part No.	Pump A194-	Shaft A13-	Nozzle A47-	Idle Tube A229-	Float A30-	Float Shaft A32-	Float Valve A233-	Float Setting	Idle Needle A43-	Gaskets A16-	Repair Kit A286-
A10-2065		794		545		32	615	7/32	564	599	*
A10-2065-P		794		545		32	615	7/32	564	599	*
A10-2301	580	853	613		764	35	614	13/64	648		*
A10-2535-1	580			551	766	32	615	7/32	564	630	*
A10-2827	591	853	754	560	764	35	614	13/64	648	646	*
A10-2848	593	1520	652	566	766	32	615	7/32	564	CF-653	1629
A10-2948		1520	684	541	766	32	615	7/32	564	CF-653	815
A10-2971	593	1520	668	569	766	32	615	7/32	564	CF-653	*
A10-2971-P	593	1520	668	569	766	32	615	7/32	564	CF-653	*
A10-2983		768	667	567	766	32	615	7/32	564		*
A10-3148-1	580	853	689	572	764	35	614	13/64	648	625	*
A10-3237	593	1164	702	566	766	32	615	7/32	564	CF-653	974
A10-3323	580	853		560	764	35	614	13/64	648	646	*
A10-3346-1	593	1520	719	569	766	32	615	7/32	564	CF-653	1628
A10-3565-1	593	1520	728	569	766	32	615	7/32	564	CF-653	1630
A10-3634	580	1183	738	585	764	35	614	13/64	648	625	*
A10-3649-1	580	853	735	572	764	35	614	13/64	648	625	*
A10-3678-12	CF194-581	1521	741	587	766	32	615	7/32	564	CF-676	*
A10-3678-32	CF194-581	1521	773	587	766	32	615	7/32	564	CF-676	1623
A10-3729	593	1520	719	569	766	32	615	7/32	564	CF-653	1070
A10-3759	580	853	735	572	764	35	614	13/64	648	625	*
A10-3859	580	853	735	572	764	35	614	13/64	648	625	939
A10-3859-1	580	1533	735	572	764	35	614	13/64	648	625	1662
A10-3878	605	1522	739	590	764	35	614	13/64	648	625	1670
A10-3965-12	580	853	749	584	764	35	614	13/64	648	625	1139
A10-4115	593	1520	751	587	764	32	615	7/32	564	696	1237
A10-4164-1	591	1522	755	589	764	35	614	13/64	649	625	*
A10-4171	580	1533	757	584	764	35	614	13/64	648	646	*
A10-4191	580	853	749	584	764	35	614	13/64	648	625	*
A10-4218-1	605	1183	775	596	764	35	614	13/64	648	710	1645
A10-4233	593	1520	770	594	766	32	615	7/32	564	696	1623
A10-4240	593	1520	782	587	766	32	615	7/32	564	696	1635
A10-4252	593	1520	765	587	766	32	615	7/32	564	696	1632
A10-4404-1	605	1533	779	592	764	35	614	13/64	648	646	1643
A10-4439	593	1164	702	566	766	32	615	7/32	564	653	*
A10-4457	593	1520	782	587	766	32	615	7/32	564	696	*
A10-4495	580	1183	788	598	762	35	614	13/64	648	711	1398

Use your Marvel-Schebler Parts and Service Manual for correct parts selection. * Repair Kits for these carburetor's are not available.

Precision Replacement Parts

Replacement Part	Part No.
Screw	A15-A15
Screw	A15-A23
Screw	A15-483
Gasket	A16-A32
Gasket	A16-221
Rod	A17-383
Spring	A24-A1
Spring	A24-A10
Spring	A24-A39
Clip	A29-113
Plug	A37-4
Plug	A37-7
Packing	A44-86
Nozzle	A47-719
Nozzle	A47-728
Washer	A78-5
Washer	A78-121
Washer	A78-356

Replacement Part	Part No.
Washer	A78-357
Washer	A78-371
Plug	A80-151
Cotter Key	A82-9
Cotter Key	A82-14
Screen	A95-57
Pipe Plug	A99-8
Throttle Body	A227-930
Throttle Body	A227-1096
Throttle Body	A227-1107
Throttle Body	A227-1317-1
Throttle Body	A227-1621
Tube Assembly	A229-560
Tube Assembly	A229-569
Tube Assembly	A229-579
Tube Assembly	A229-587
Tube Assembly	A229-588
Valve	A242-505
Valve	A242-508
Valve	A242-520

Replacement Part	Part No.
Valve	A242-528
Valve	A242-537
Long Lock Kit	A666-652

Repair Kits

Kit Number	Carburetor Part No.
A286-813	A10-2948
A286-815	A10-3168
A286-939	A10-3859
A286-970	A10-3346-1
A286-1616	A10-3237
A286-1630	A10-3565-1
A286-1070	A10-3729
A286-1139	A10-3965-12
A286-1190	A10-3634
A286-1237	A10-4057, -4057-1, -4404
A286-1237	A10-4115
A286-1428	A10-4495
A286-1428	A10-4240

ENGINE PARTS and ACCESSORIES

Bendix Stromberg Carburetor NA-S3A1 Exploded View

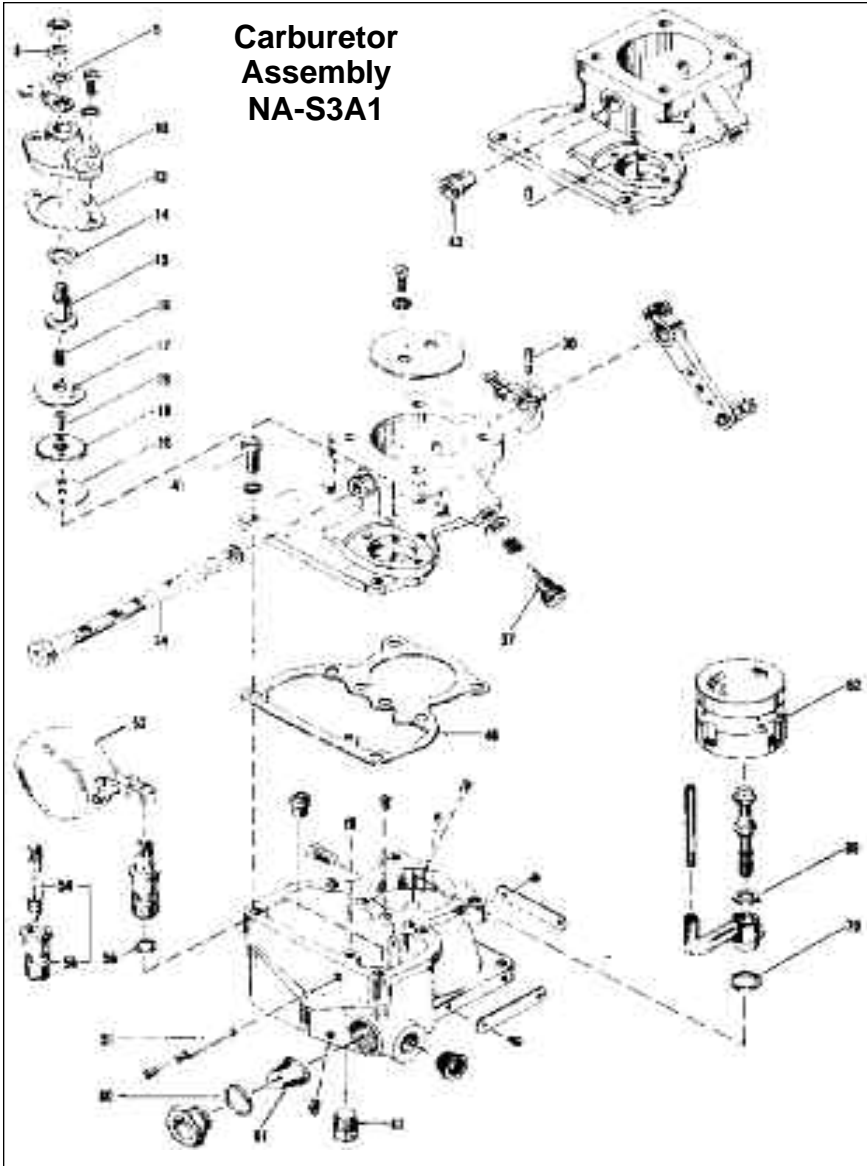

Index No.	Part No.	Description	Qty.
8	AN315-3	NUT, no. 10-32	1
9	NAS1149F0363P	WASHER	1
10	P61037	COVER ASSEMBLY, mixture control	1
13	P61033	GASKET, mixture control cover	1
14	384667	GASKET	1
15	P61034	STEM, mixture control	1
16	P8770	SPRING, helical (No Longer Available)	1
17	P61030	PLATE, mixture control valve, upper	1
18	P61031	PLATE, mixture control valve, lower	1
19	AN505-8-6	SCREW, No. 8-32 by 3/8 inch	1
20	P61035	GASKET	1
30	P21267-1	PIN, split taper no. 4/0	AR
34	P16151	SHAFT ASSEMBLY, throttle	1
37	P16177	VALVE ASSEMBLY, idle	1
41	P6550	SCREW, fillister head 1/4-20 by 5/8 inch	6
43	P16169	BUSHING, throttle shaft (No Longer Available)	2
46	P16155	GASKET	1

Index No.	Part No.	Description	Qty.
47	MS20913-2D	PLUG (Bendix P8505)	1
51	P16160	PIN, fulcrum	1
52	P16156	LEVER AND FLOAT ASSY (No Longer Available)	1
54	2523047	NEEDLE, float (390077)	1
55	P17247	SEAT, needle valve (no longer available)	1
56	P16165	GASKET, 1/64-inch thick (see note)	1
56	P12999	GASKET, 1/32-inch thick (see note)	1
56	P16166	GASKET, 3/64-inch thick (see note)	1
56	P16167	GASKET, 1/16-inch thick (see note)	1
60	174S-22	GASKET, copper	1
61	P12958	STRAINER ASSEMBLY	1
62	P16176-1/38	1-3/8-inch Venturi (No Longer Available)	1
69	P5329	GASKET	1
70	P2885	GASKET	1
	380189	GASKET KIT (not illustrated)	

Note: When necessary to change the float level, one of these gaskets may be used under the float needle seat in place of P12999.

All items on this page are Price Code 250 unless otherwise noted

Price and availability subject to change without notice. Univair's Toll Free Sales: 1-888-433-5433

ENGINE PARTS and ACCESSORIES

Service Bulletin Fuel Systems

Published By Product Support Department

No. ACSD-84
Rev. No. 1
Issued 6-1-64
Revised 7-15-72
Page 1 of 4

SUBJECT: CARBURETOR, BENDIX-STROMBERG MODEL# NA-53A1 NA-53B AND NA-503A1 - FLOAT NEEDLE VALVE PIN 990011 - REPLACEMENT OF

REFERENCE: Letter, Continuation R-2, Power(1) to Bendix (J. E. Hartzer) dated 26 June 1963.

PUBLICATIONS AFFECTED:

- | | |
|------------------------|--|
| (a) Form No. 15 91B | Handbook Overhaul Instructions, Float Carburetor Model NA-53A1 dated 15 December 1955. |
| (b) Form No. 15 591B | Supplement to Handbook Overhaul Instructions, Float Carburetor Model NA-53A1 dated 15 December 1961. |
| (c) Form No. 15 103B | Illustrated Parts Breakdown, Float Carburetor Model NA-53A1 dated 1 November 1958. |
| (d) Form No. 15 510311 | Supplement to Illustrated Parts Breakdown, Float Carburetor Model NA-53A1 dated 1 November 1958. |

REASON FOR BILLING: To provide a float needle valve made of Delrin, an ivory colored acetal plastic, in lieu of the rubber tipped stainless steel needle. Material change made to remove rubber age control requirement, reduce cost and provide an improved service life material. Reason for Revision:

1. To add instructions for float lever weight.
2. To add seal part number under application.

APPLICATION:

Engine	Carburetor Model	Part# List	Seal P/N
A-65, 0-170 0-5, -7	NA-53A1	A-18033(B)-5	983911
A-75		A-30177(B)-5	983911
C-75		380162-2	983911
C-85-12		380167-4	983911
C-75-12		380171-2	984525
C-85-12		380172-2	984525
C-75-12		380174-2	983911
C-90-12F		380231-3	983911
C-90-8F		391090-2	983911
C-90-12F		391156-2	984525
C-90-14F		391229-2	983911
C-90-14F		391257-2	984525
A-65-B		391718-2	564525
A-55-B	NA-53B	350155-2	983911
A-55-B		380158-1	983911
A-55-B		380206-1	984525
A-100-1	NA-503A1	380188-2	983911
A-100-1		380175-1	984525



**Energy Controls
Division**

717 N. Bendix Dr., South Bend, Ind 46620

ENGINE PARTS and ACCESSORIES

ACSB No -14, Rev 1

SUBJECT: CARBURETOR BENDIC-STROMBERG MODEL 8 NA-53A1, NA-53B AND NA-53B A1 FLOAT NEEDLE VALVE P/N 380077 - REPLACEMENT OF.

COMPLIANCE:

Operating Activities: For information only

Overhaul Activities: Comply at time of carburetor overhaul when stock of float needle P/N 380077 has been exhausted.

DETAILED INSTRUCTIONS:

1. At time of carburetor overhaul, replace the rubber tipped stainless steel float needle valve P/N 380077 with the new Delrin plastic needle valve P/N 3523047.
2. The needle seal, P/N 383511, 383912 or 384585 as applicable (see application), need not be replaced unless the valve contact area on the seat has been damaged or deformed to the extent that the seat is no longer considered to be serviceable.
3. The Delrin needle requires a weight added to the float lever. The weight must weigh approximately four grams. Refer to Figure 1 for instructions for fabrication of the weight. Sift solder the weight to the float lever in the location indicated in Figure 2. Use a 300 or 500 watt electric iron for this soldering operation to get the solder to flow. Keep the float and lever wrapped in a wet cloth to prevent melting other solder joints.

CAUTION

Be certain the added weight does not strike the aluminum carburetor bowl at any position of the float. Some corners of the added weight will have to be tailored for clearance.

4. Continue assembling the carburetor in the usual manner.
5. The Delrin material is not readily affected by the usual cleaning agents used during normal carburetor overhaul, however, it is recommended that the needle not be subjected to cleaning in a trichloroethylene depressor or by use of acetone. It is suggested that the material used for needle cleaning be confined to the usual naphtha type cleaning solvents.

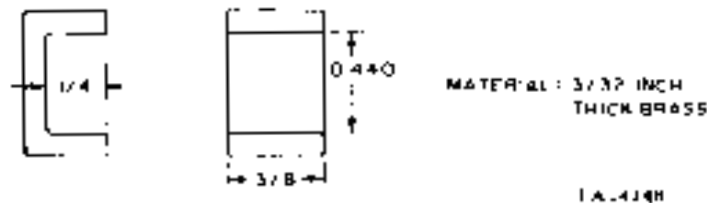

Figure 1

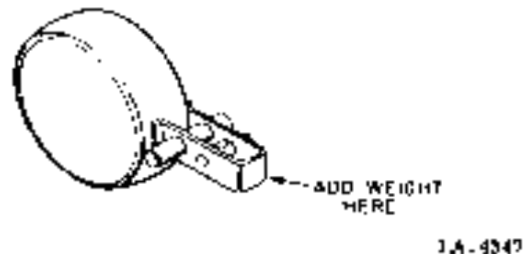

Figure 2

ENGINE PARTS and ACCESSORIES

ACSB No. 84, Rev. 1

SUBJECT: CARBURATOR, BENDIX STROMBERG MODELS NA-53A1, NA-53H AND NA-53A1 - FLOVAL NEEDLE VALVE P/N 393077 - REPLACEMENT OF

- 6. Carburetor reidentification is not required.
- 7. The existing calibration test and limits are not affected by this bulletin.

PARTS REQUIRED:

Name of Part	Bendix P/N	Quantity/Unit	Source
Valve, Float Needle	2523047	1	(1)

NOTE:

Effective with the introduction of the Helium needle valve it will no longer be necessary to procure the float needle valve and seat assembly as a matched assembly. However, once in service use, the valves and seats should not be interchangeably interchanged with other used parts. Valve P/N 2523047 and seat P/N 361911, 303922 or 364581, as applicable, may be procured as separate items.

SOURCE OF PARTS:

- (1) Procure through the normal supply channels.

PARTS REMOVAL:

Name of Part	Bendix P/N	Quantity/Unit	Disposition
Valve, Float Needle	393077	1	(1) (2)

- (1) Scrap

DISPOSITION OF LIKE PARTS IN STOCK:

- (2) Use until exhausted

SPECIAL MATERIALS REQUIRED: None

SPECIAL TOOLS REQUIRED: None

MAN HOURS REQUIRED: No effect.

WEIGHT AND BALANCE DATA: No effect.

Continental AC Pump Adapter Kit

Complies with AD 81-07-06 Teledyne Continental Motors, which applies to A-65, A-75, C-75, C-85, C-90, A-100, C-125, and O-200 engines equipped with AC fuel pumps, part numbers 40585, 40695 or 631391. Kit consists of:

- Screen.....643913
- Gasket643914
- Screw643915

The Above parts are only available in the AF-6561 Kit.

Part Number AF-6561

PC 201

Complete Piper Gascolator

FAA/PMA Approved

For J3, PA11, PA12, 14, 15, 16, 17, 18, 20, 22

.....**PC 150**.....U14330-002

1/2" Gascolator with Metal Bowl and Quick Drain



Gascolator for use with 1/2" fuel lines similar to U14330-002 except with large head for 1/2" fuel system.

- Complete 1/2" Gascolator.....1702*
- 1/2" Gascolator Head only.....1700*
- 1/2" Gascolator Screen only.....1701*

*For Homebuilt use only.

PC 150

Gascolator Parts



- 2 1/8 inch Gasket U85012-032
- 2 inch Gasket **PC 299**..... LAT-08
- Gascolator Screen U750-272
- 2 1/8 inch Top.....U87477-002
- 2 1/8 inch BowlU12764-000
- BailU494-644

PC 150

ENGINE PARTS and ACCESSORIES

Univair Shielded Ignition Leads

To order the correct lead, select the correct ignition lead model from this page.

Example: An engine with 5/8 X 24 spark plugs and a Scintilla S6 Series magnetos with threaded cap uses a 101 model lead.

Threaded high tension terminal plates must be used when upgrading from unshielded to shielded ignition leads. See page 160 for Bendix Magneto details. See page 161 for Eisemann Magneto details.

Find the right lead length!

If you are replacing an existing lead, measure the exact length, ferrule to ferrule, and use this as the last part of your order No. Leads are manufactured in 3" increments from 19" thru 60".

Example: You want a 101 Series lead. Ferrule to ferrule measurement is 31 inches long. The Univair part number is 101-31. Prices listed in Price Code 290.

MAGNETO SELECTION	SPARK PLUG SELECTION
	Spark Plug 5/8 X 24
Eisemann LA4.....	102
Eisemann LA6.....	102
Scintilla SF4 Series.....	104
Scintilla SF6 Series.....	104
Scintilla S4 Series with Threaded Cap.....	101
Scintilla S6 Series with Threaded Cap.....	101

Use the engine, cylinder and routing chart. Correct length is shown as dash number. Make selection of as many leads as your engine requires.

The routing chart lists only the 101 Series leads. If, for example, you require a 102 Series lead (for Eisemann series magnetos), 33 inches long, the chart will list 101-33. You will need to order a 102-33 lead. If you require a 104 series lead (for Scintilla magnetos), order a 104-33, and so on.

Prices listed in Price Code 290.

SHIES	ELBOW DESIGN	TERMINAL DESIGN SPARK PLUG END	TERMINAL DESIGN MAGNETO END	WIRE SIZE & TYPE	AVAILABLE IN THESE DASH NUMBERS IN 3" INCREMENTS
101	5/8 x 24 90°	Standard Glaze Ceramic 9x16 Insulator and Silicone Rubber Grommet	11/16 x 24 Male Thread Square Head Nut	7mm Shielded	19-31 thru 60-31
102	5/8 x 24 90°	Standard Glaze Ceramic 9x16 Insulator and Silicone Rubber Grommet	11/16 x 24 Female Thread Hex Head Nut	7mm Shielded	19-31 thru 60-31
104	5/8 x 24 90°	Standard Glaze Ceramic 9x16 Insulator and Silicone Rubber Grommet	3/4 x 16 Female Thread Knurled Barrel Nut	7mm Shielded	19-31 thru 60-31 64-57 thru 64-60

Shielded Ignition Leads Lengths shown are "Ferrule to Ferrule"



Model 101

5/8 X 24 Plugs and Bendix Scintilla S4, S6 Series, with threaded cap, and Bendix S20, S200, S2000, S1200 and 102000 Magnets with threaded 11/16 X 24 male outlets.

Model 102

5/8 X 24 Plugs and Eisemann LA-1, LA-6 Magnets

Note: Only 7mm is available in this model.

Model 104

5/8 X 24 Plugs and Scintilla SF-1 or SF-6 Magnets

Note: Only 7mm is available in this model.

ENGINE PARTS and ACCESSORIES

Univair Shielded Ignition Leads Model 101, 102 and 104 Leads FAA-PMA Approved

Model 101 Leads fit:

SPENDIX SC-N111-V-MAG-N-10
S1 or S1-S1-5 with 1/16 X 2-3/16 In. Thread
and spark plugs with 5/8 X 2-1/4 standard stud
length

Spark Plug Leads: Glazed Ceramic 4-19 Fischer
Inc. or Solvex Rad-Fast Throughput - 5mm
Shielded Wire



To determine your requirement:

- Check your spark plug
- Check your magnetos
- Check the chart under your engine

All the information is at your disposal under mag
your lead is given in the chart on this and the
preceding page.

The length of the lead is shown in the chart
and your spark plug engine length is measured
from a reference with one end designated by dash
number (i.e., 01-12 = 12 inch lead).

Continental Engines

ENGINE MODEL A5C, A5S, A7S, A80					
Bendix S4RH-26-21 Plug Nut 5/8 - 24					
Cyl.	Mag.	Lead	Cyl.	Mag.	Lead
11	1R	10" 34	12	1	10" 34
12	3L	10" 30	13	3R	10" 34
13	2H	10" 11	14	4	10" 29
14	4	10" 8	15	4R	10" 31

Lead Set 101-105

ENGINE MODEL C75-12, 12E, 12FJ, C85 12F, 12FJ, C90 12, O200A					
Bendix S4LN-21 Plug Nut 5/8 - 24					
Cyl.	Mag.	Lead	Cyl.	Mag.	Lead
11	1R	10" 34	12	1	10" 34
12	3R	10" 32	13	3	10" 30
14	2H	10" 11	15	4	10" 29
16	4R	10" 30	17	4	10" 27

Lead Set 101-106

ENGINE MODEL C85 B, 8F, C90 BF, 8FJ					
Bendix S4LN-21 Plug Nut 5/8 - 24					
Cyl.	Mag.	Lead	Cyl.	Mag.	Lead
11	1R	10" 34	12	1	10" 34
12	3R	10" 32	13	3	10" 30
14	2H	10" 11	15	4	10" 29
16	4R	10" 30	17	4	10" 27

Lead Set 101-107

Chart Symbol Definitions:					
MAG	MAG.	MAG.	MAG.	MAG.	MAG.
1	2	3	4	5	6
7	8	9	10	11	12
13	14	15	16	17	18
19	20	21	22	23	24
25	26	27	28	29	30
31	32	33	34	35	36
37	38	39	40	41	42
43	44	45	46	47	48
49	50	51	52	53	54
55	56	57	58	59	60
61	62	63	64	65	66
67	68	69	70	71	72
73	74	75	76	77	78
79	80	81	82	83	84
85	86	87	88	89	90
91	92	93	94	95	96
97	98	99	00	01	02
03	04	05	06	07	08
09	10	11	12	13	14
15	16	17	18	19	20
21	22	23	24	25	26
27	28	29	30	31	32
33	34	35	36	37	38
39	40	41	42	43	44
45	46	47	48	49	50
51	52	53	54	55	56
57	58	59	60	61	62
63	64	65	66	67	68
69	70	71	72	73	74
75	76	77	78	79	80
81	82	83	84	85	86
87	88	89	90	91	92
93	94	95	96	97	98
99	00	01	02	03	04
05	06	07	08	09	10
11	12	13	14	15	16
17	18	19	20	21	22
23	24	25	26	27	28
29	30	31	32	33	34
35	36	37	38	39	40
41	42	43	44	45	46
47	48	49	50	51	52
53	54	55	56	57	58
59	60	61	62	63	64
65	66	67	68	69	70
71	72	73	74	75	76
77	78	79	80	81	82
83	84	85	86	87	88
89	90	91	92	93	94
95	96	97	98	99	00
01	02	03	04	05	06
07	08	09	10	11	12
13	14	15	16	17	18
19	20	21	22	23	24
25	26	27	28	29	30
31	32	33	34	35	36
37	38	39	40	41	42
43	44	45	46	47	48
49	50	51	52	53	54
55	56	57	58	59	60
61	62	63	64	65	66
67	68	69	70	71	72
73	74	75	76	77	78
79	80	81	82	83	84
85	86	87	88	89	90
91	92	93	94	95	96
97	98	99	00	01	02
03	04	05	06	07	08
09	10	11	12	13	14
15	16	17	18	19	20
21	22	23	24	25	26
27	28	29	30	31	32
33	34	35	36	37	38
39	40	41	42	43	44
45	46	47	48	49	50
51	52	53	54	55	56
57	58	59	60	61	62
63	64	65	66	67	68
69	70	71	72	73	74
75	76	77	78	79	80
81	82	83	84	85	86
87	88	89	90	91	92
93	94	95	96	97	98
99	00	01	02	03	04
05	06	07	08	09	10
11	12	13	14	15	16
17	18	19	20	21	22
23	24	25	26	27	28
29	30	31	32	33	34
35	36	37	38	39	40
41	42	43	44	45	46
47	48	49	50	51	52
53	54	55	56	57	58
59	60	61	62	63	64
65	66	67	68	69	70
71	72	73	74	75	76
77	78	79	80	81	82
83	84	85	86	87	88
89	90	91	92	93	94
95	96	97	98	99	00

ENGINE MODEL G125, G145, O30G					
Bendix S6LN-21 Plug Nut 5/8 - 24					
Cyl.	Mag.	Lead	Cyl.	Mag.	Lead
11	1R	10" 33	11	1	10" 29
12	1R	10" 35	12	4	10" 35
13	2R	10" 27	13	2	10" 35
14	4R	10" 29	14	5	10" 27
15	5R	10" 27	15	5	10" 27
16	2R	10" 29	16	2	10" 29

Lead Set 101-108

ENGINE MODEL GQ-300A					
Bendix S6RN-21 Plug Nut 5/8 - 24					
Cyl.	Mag.	Lead	Cyl.	Mag.	Lead
11	1R	10" 35	11	1	10" 35
12	4R	10" 35	12	4	10" 31
13	2R	10" 29	13	2	10" 29
14	2R	10" 29	14	2	10" 27
15	5R	10" 25	15	3	10" 27
16	2R	10" 29	16	2	10" 29

Lead Set 101-109

ENGINE MODEL E185, E185, E225					
Bendix S6LN-21 Plug Nut 5/8 - 24					
Cyl.	Mag.	Lead	Cyl.	Mag.	Lead
11	1R	10" 35	11	1	10" 35
12	4R	10" 27	12	4	10" 31
13	2R	10" 25	13	2	10" 29
14	2R	10" 29	14	2	10" 25
15	5R	10" 29	15	5	10" 27
16	2R	10" 29	16	2	10" 29

Lead Set 101-110

ENGINE MODEL E155, E185, E225 CROSSLINE					
Bendix S6LN-21 Plug Nut 5/8 - 24					
Cyl.	Mag.	Lead	Cyl.	Mag.	Lead
11	1R	10" 31	11	1	10" 31
12	2R	10" 27	12	4	10" 31
13	3R	10" 27	13	2	10" 29
14	2R	10" 27	14	4	10" 31
15	2R	10" 27	15	2	10" 29
16	2R	10" 27	16	2	10" 29

Lead Set 101-111

ENGINE MODEL O470-4, -11, -13A					
Bendix S6LN-21 Plug Nut 5/8 - 24					
Cyl.	Mag.	Lead	Cyl.	Mag.	Lead
11	1R	10" 27	11	1	10" 31
12	4R	10" 29	12	4	10" 31
13	3R	10" 27	13	2	10" 29
14	2R	10" 27	14	2	10" 29
15	2R	10" 27	15	1	10" 29
16	2	10" 27	16	2	10" 29

Lead Set 101-112

ENGINE MODEL O470B, -J, -K, -L, -M, -R, etc. IO 470 Series, IO 520 Series					
Bendix S6RS-25 Plug Nut 5/8 - 24					
Cyl.	Mag.	Lead	Cyl.	Mag.	Lead
11	1R	10" 31	11	1	10" 31
12	11	10" 27	12	1R	10" 30
13	2R	10" 27	13	2R	10" 29
14	4R	10" 27	14	4R	10" 29
15	2R	10" 27	15	2	10" 31
16	2	10" 27	16	2R	10" 29

Lead Set 101-113

ENGINE PARTS and ACCESSORIES

Univair Shielded Ignition Leads (continued)

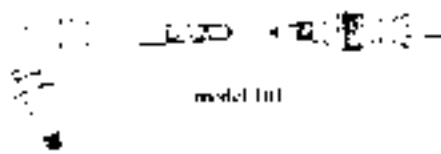

Flare Design
S&S
7

Terminal Design
Spark Plug Top
Shielded Lead
Terminal Nut
Terminal Plug
Sizing Plug
Terminal

Terminal Design
Magneto Coil
H, SA, 24
M, L, 24
Voltage 300
No

Wire Size
and Type
Type S, 24

Length
Available
in 3 foot
increments
in 15
foot lot

Lycoming Engines

ENGINE MODEL O235 O-290

Bandix 56LN-20-21
Plug Nut 5/8 - 24

Cyl.	Mag.	Lead	Cyl.	Mag.	Lead
11	1	101-21	11	1	101-21
12	3	101-21	12	3	101-21
13	2	101-21	13	2	101-21
14	4	101-21	14	4	101-21

Lead Set.....101-114

ENGINE MODEL O320, O300-A1A

Bandix 56LN-21
Plug Nut 5/8 - 24

Cyl.	Mag.	Lead	Cyl.	Mag.	Lead
11	1	101-21	11	1	101-21
12	3	101-21	12	3	101-21
13	2	101-21	13	2	101-21
14	4	101-21	14	4	101-21

Lead Set.....101-115

ENGINE MODEL O320A -B, O380

Bandix 56LN-20-21
Plug Nut 5/8 - 24

Cyl.	Mag.	Lead	Cyl.	Mag.	Lead
11	1	101-21	11	1	101-21
12	3	101-21	12	3	101-21
13	2	101-21	13	2	101-21
14	4	101-21	14	4	101-21

Lead Set.....101-116

ENGINE MODEL O435A

Bandix 56LN-20-21
Plug Nut 5/8 - 24

Cyl.	Mag.	Lead	Cyl.	Mag.	Lead
11	1	101-21	11	1	101-21
12	3	101-21	12	3	101-21
13	2	101-21	13	2	101-21
14	4	101-21	14	4	101-21
15	2	101-21	15	2	101-21
16	3	101-21	16	3	101-21
17	1	101-21	17	1	101-21

Lead Set.....101-117

Chart Symbol Definitions:

Mag. = Magneto Coil
Lead = Lead
Cyl. = Cylinder
R = Right

ENGINE MODEL O435-23

Bandix 56LN-20-RN-21
Plug Nut 5/8 - 24

Cyl.	Mag.	Lead	Cyl.	Mag.	Lead
11	1	101-21	11	1	101-21
12	3	101-21	12	3	101-21
13	2	101-21	13	2	101-21
14	4	101-21	14	4	101-21
15	2	101-21	15	2	101-21
16	3	101-21	16	3	101-21

Lead Set.....101-118

ENGINE MODEL O640

Bandix 56LN-20-21
Plug Nut 5/8 - 24

Cyl.	Mag.	Lead	Cyl.	Mag.	Lead
11	1	101-21	11	1	101-21
12	3	101-21	12	3	101-21
13	2	101-21	13	2	101-21
14	4	101-21	14	4	101-21
15	2	101-21	15	2	101-21
16	3	101-21	16	3	101-21

Lead Set.....101-119

ENGINE MODEL O648D C2D6, O648D C2

Bandix 56LN-20-21
Plug Nut 5/8 - 24

Cyl.	Mag.	Lead	Cyl.	Mag.	Lead
11	1	101-21	11	1	101-21
12	3	101-21	12	3	101-21
13	2	101-21	13	2	101-21
14	4	101-21	14	4	101-21
15	2	101-21	15	2	101-21
16	3	101-21	16	3	101-21

Lead Set.....101-120

ENGINE MODEL O5048D-A1A-6

Bandix 56LN-20-21
Plug Nut 5/8 - 24

Cyl.	Mag.	Lead	Cyl.	Mag.	Lead
11	1	101-21	11	1	101-21
12	3	101-21	12	3	101-21
13	2	101-21	13	2	101-21
14	4	101-21	14	4	101-21
15	2	101-21	15	2	101-21
16	3	101-21	16	3	101-21
17	1	101-21	17	1	101-21

Lead Set.....101-121

ENGINE MODEL O6435-A1B, A1C, A1D, O648D-C1B, -C1C, O5048D-A1A -A1AK

Bandix 56LN-20-RN-21
Plug Nut 5/8 - 24

Cyl.	Mag.	Lead	Cyl.	Mag.	Lead
11	1	101-21	11	1	101-21
12	3	101-21	12	3	101-21
13	2	101-21	13	2	101-21
14	4	101-21	14	4	101-21
15	2	101-21	15	2	101-21
16	3	101-21	16	3	101-21

Lead Set.....101-122

ENGINE MODEL O6435-C2, -C2B, O648D-F6

Bandix 56LN-20-21
Plug Nut 5/8 - 24

Cyl.	Mag.	Lead	Cyl.	Mag.	Lead
11	1	101-21	11	1	101-21
12	3	101-21	12	3	101-21
13	2	101-21	13	2	101-21
14	4	101-21	14	4	101-21
15	2	101-21	15	2	101-21
16	3	101-21	16	3	101-21

Lead Set.....101-123

Franklin Engines

ENGINE MODEL KAA-150-10, -101

Bandix 56RN-21
Plug Nut 5/8 - 24

Cyl.	Mag.	Lead	Cyl.	Mag.	Lead
11	1	101-21	11	1	101-21
12	3	101-21	12	3	101-21
13	2	101-21	13	2	101-21
14	4	101-21	14	4	101-21
15	2	101-21	15	2	101-21
16	3	101-21	16	3	101-21

Lead Set.....101-124

ENGINE MODEL KAA-165-10

Bandix 56RN-21
Plug Nut 5/8 - 24

Cyl.	Mag.	Lead	Cyl.	Mag.	Lead
11	1	101-21	11	1	101-21
12	3	101-21	12	3	101-21
13	2	101-21	13	2	101-21
14	4	101-21	14	4	101-21
15	2	101-21	15	2	101-21
16	3	101-21	16	3	101-21

Lead Set.....101-125

ENGINE PARTS and ACCESSORIES

Bendix Scintilla Magneto Spares

Univair has acquired various Bendix Scintilla spares, listed below. They are available while quantities last.

Part No.	Description	Part No.	Description	Part No.	Description	Part No.	Description	Part No.	Description
2-126	gasket	2-459	block	10-163049	bushing	10-320394	plate	10-51653	magnet
2-138	washer	2-460	block	10-163131	condenser	10-32438	washer	10-51676	condenser
2-139-1	shim	2-462	bearing (nd 15)	10-163136	cover	10-3263	bushing	10-51677	washer
2-139-2	shim	2-463	bearing (nd 17)	10-163151	nut	10-3316	insulator	10-51678	oil slinger
2-139-3	shim	2-529	gasket	10-163171	RH breaker assy.	10-3320	contact	10-52305	ground term. kit
2-139-4	shim	2-621	cam	10-163177	nut	10-33630	block	10-52305-1	ground term. kit
2-139-5	shim	2-633	cam	10-163178	nut	10-3383	contact	10-52306	ground term. kit
2-139-6	shim	2-648	plug	10-163292	housing	10-3424	plate	10-52307	washer
2-140	washer	2-649	plug	10-163347-2	coil	10-3429	follower	10-52320	gasket
2-141-1	shim	2-681	lock	10-163374	strip	10-3464-1	shim spacer	10-5286-11	shim washer
2-141-2	shim	2-693	electrode	10-163384	disc	10-3464-2	shim spacer	10-5289-12	shim washer
2-141-3	shim	2-696-z	cylinder	10-16481	screw	10-3464-3	shim spacer	10-5289-13	shim washer
2-141-4	shim	2-755	condenser	10-16483	screw	10-3464-4	shim spacer	10-5289-14	shim washer
2-141-5	shim	2-755y	condenser	10-16487	screw	10-349357-2	cam	10-52901	sleeve insulator
2-141-6	shim	2-764	brush	10-16584	screw	10-349371	coupling	10-52903	body
2-146	spring	2-80	clamp	10-16640	felt	10-3503	washer	10-52917	housing
2-148	plate	2-828-z	woodruff key	10-16768	screw	10-350447a	ps-sc kit	10-52931	housing
2-152-2	pin	2-867	block	10-16898	screw	10-357078	bearing	10-52934	grommet
2-161-3	shim washer	2-965	washer	10-17900-y	oil seal	10-357094	contact	10-52936	scintilla kit
2-161-4	washer	2-995	washer	10-180016-1	tube	10-357097	breaker	10-52937	cover
2-161-6	shim washer	10-102090	spring	10-180016-31	tube	10-357164	coil assembly	10-52938-y	cover
2-182	woodruff key	10-102092	spring	10-180016-32	tube	10-357165	coil	10-52939-y	cover
2-184	screw	10-116197	ret. vent screw	10-187468	dial	10-357200-1	switch	10-52941	housing
2-187	screw	10-12036-y	cylinder	10-19021	clip	10-357290-1	switch	10-52942	housing
2-189-1	shim washer	10-124545	key	10-19253	gasket	10-357424	dist. block	10-52943	housing
2-189-2	shim washer	10-126676	placard	10-19254	plug	10-357584	gear kit	10-52944	housing
2-189-3	shim washer	10-12719	spring	10-19722	breaker cover screw	10-357592	oil seal	10-52945	magnet
2-189-4	shim washer	10-12945	magneto cover	10-20223	breaker cam	10-35936-10	screw	10-52947	magnet
2-189-5	shim washer	10-13222	leather plug	10-20237	contact assy.	10-35936-6	screw	10-52948	rotor
2-189-6	shim washer	10-13358	cyl. distributor	10-2024	lock ring	10-35936-7	screw	10-52949	block
2-194	lock washer	10-13370	screw	10-20490	screw	10-35937-10	screw	10-52952-t	points
2-199-2	shim washer	10-13625-z	coil	10-21344	screw	10-3657	nut outlet plate	10-52958	block
2-199-3	shim washer	10-13636	clamp assembly	10-21495	carbon brush	10-3659	washer	10-5413-y	seal
2-199-4	shim washer	10-13775	gasket	10-21529	bolt	10-3677	washer	10-5414	retainer
2-199-5	shim washer	10-13777	retainer	10-21585	gear	10-3743	ferrule	10-5509	felt pad
2-216-z	oil cap	10-13795	shield	10-21721	felt	10-37621	finger	10-5510-z	distributor block
2-217	axle	10-13796	side vent spacer	10-21917-w	coil	10-37626	condenser	10-5511-z	distributor block
2-219	spacer	10-13797	screen	10-22067	screw	10-377007	lock ign. switch	10-5600	screw
2-231	collector	10-14268	washer	10-22529	carbon brush	10-3793	lock washer	10-56153	spring
2-247-y	screw	10-14576	finger	10-22560-3	magneto	10-382584	breaker	10-56507	grommet
2-274	felt strip	10-14857	coil	10-25458	gear	10-382585	breaker	10-56513	pin
2-281	lock washer	10-14990	nut	10-25725	contact	10-382681	condenser	10-56591	bushing
2-292-z	gear	10-156390	washer	10-25788	bushing d/e	10-391247-2	cam	10-57442	cam
2-295-z	woodruff key	10-157109y	contact	10-25789	spacer	10-391248-4	cam	10-57443	cam
2-311	carbon brush	10-157120-y	gear mag.	10-2617	grommet	10-400167-4	cam	10-5752	cable clip
2-317	disc (p)	10-157123	gear	10-26198	washer	10-400314	impulse coupling	10-59432	clamp
2-322	disc (2)	10-157123-y	gear	10-26199	tube insulator		with core charge	10-59437	impulse cam
2-325	disc (5)	10-157128-w	breaker	10-2633	ring	10-40810-2	grommet	10-59439	cam assembly
2-326	disc (6)	10-157134	vented plug	10-2674	grommet	10-4092	nut	10-59449	plate
2-327	disc (7)	10-157135	plug	10-29005	contact screw	10-4093	washer	10-59451	cover
2-328	disc (8)	10-157197	gear	10-29049	front end plate	10-4140	leather plug	10-59454	rotor assembly
2-329	disc (9)	10-158152	connector	10-2936-d2	bearing	10-41810-2	plug assembly	10-59456	strip
2-333	block	10-15823	washer	10-2976	support	10-4308	bearing	10-59457	vent
2-334	block	10-15827-y	rotor assembly	10-2980	terminal	10-4744	electrode	10-59471	impulse coupling
2-339	washer	10-160844	brush	10-30299	nut	10-50708	cam breaker	10-59474	impulse coupling
2-392	electrode	10-160858	housing	10-31282	retaining ring	10-50727-y	housing	10-620039-5	plate
2-393	cotter pin	10-16140-z	ground shield	10-3154-2	leather plug	10-50737	spring	10-6498	housing
2-440	spring	10-16203	insulator	10-320050	grommet	10-50739	grommet	10-65394	ignition coil
2-453	bride	10-163012	eyelet	10-320283	clamp	10-50746	micarta gear	10-7030	ferrule
						10-50746y	gear	10-70344-w	breaker assy.
						10-50752	felt washer	10-70370	impulse coupling
						10-50753	washer	10-70371	body
						10-50754	gear	10-7101	block spacer
						10-50766	plate	10-7308	spacer
						10-50771	grommet	10-7441	retainer
						10-50772y	cam	10-7453	felt washer
						10-50775	screw	10-7461-2	condenser
						10-50777	plate	10-74810-2p	insert
						10-50779	large gear	10-7611	washer
						10-51218	grommet	10-76231	breaker assembly
						10-51266	spring	10-76232	body
						10-51332	body	10-7658	screw
						10-51354	washer	10-7662	screw
						10-51370	washer	10-7713	condenser
						10-51390	stop pin	10-79011	stop pin
						10-51395	body	10-79019-y	cover
						10-51612	bushing	10-8032	lock
						10-51613	washer	10-8162	plug
						10-51643	nut	10-81703	coil
						10-51652-y	nut	10-81710	screw

New and Rebuilt Magnetos — Limited Quantities!

Model No.	Reconditioned Outright Part No.
S4LN-20.....(new outright only)	10-51360-29
S4LN-21	10-51360-37-RO
S6LN-21	10-51365-39-RO
S6LN-25.....(new outright only)	10-79020-6
S6RN-200.....	10-163010-15-RO
S6RN-201.....	10-163020-3-RO
S6RN-204.....	10-163050-1-RO
S6RN-205.....	10-163060-1-RO

These are either new or reconditioned magnetos that are several years old since reconditioning. They may not comply with applicable airworthiness directives. Limited quantities. All magnetos are sold as is.

ENGINE PARTS and ACCESSORIES

Bendix Aircraft Magnetos



S6LN-20



S6LN-21

For converting Bendix S6 series magnetos to a shielded system, you will require a High Tension Terminal Kit (see above). The part number you will require will be found on the chart at right. Ground Terminal Kit part numbers may also be found on this chart.



Magneto Noise filter



Magneto Noise filter.....A293

Bendix High Tension Terminal Kit

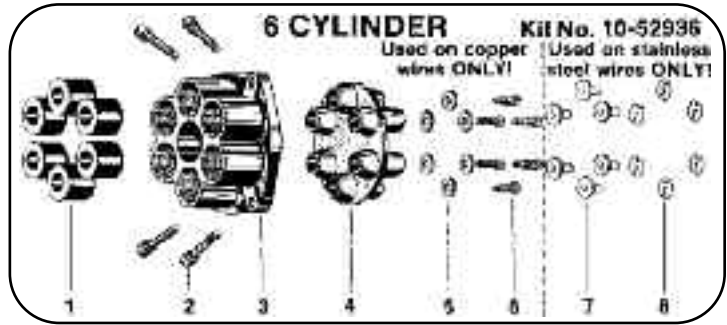

Ref. No.	Part No.	No. Req.	Description
1	10-52934	6	Grommet (cable protection, used with non-shielding installations)
2	10-35937-10	4	Screw and Lock Washer (cable outlet plate)
3	10-50766	1	Plate—cable outlet (threaded outlets)
4	10-50771	1	Grommet—cable outlet
5	10-8785	6	Washer—plain (H.T. cable screw, used only with copper conductor cable)
6	10-14215	6	Screw (H.T. cable)
7	10-163012	6	Eyelet—H.T. cable contact (used only with stainless steel conductor cable)
8	10-51677	6	Washer—alternate method of securing stainless steel wires

We have many other Bendix parts in stock.
Please call Univair at:
Toll Free 1-888-433-5433

COMPONENTS FOR COMPLETE MAGNETO INSTALLATION

(Each magneto requires a high tension and a ground terminal kit, as shown to the left.)

MAGNETO		HIGH TENSION TERM KIT		GROUND TERM KIT	
Type	Mfg Reference No.	Replaces Part No.	Part No.	Part No.	Part No.
S6LN-20	10-51296-21	10-51295-18	10-52936	10-52305-1	10-52305-1
S6LN-21	10-51176-12	10-51295-23	10-52936	10-52305-1	10-52305-1
S6LN-22	10-51280-22	10-51295-25	10-52936	10-52305-1	10-52305-1
S6LN-23	10-51316-24	10-51295-26	10-52936	10-52305-1	10-52305-1
S6LN-24	10-51368-28	10-51295-27	10-52936	10-52305-1	10-52305-1
S6LN-25	10-51369-40	10-51295-27-1	10-52936	10-52305-1	10-52305-1
S6LN-26	10-51369-41	10-51295-27	10-52936	10-52305-1	10-52305-1
S6LN-27	10-51369-42	10-51295-27	10-52936	10-52305-1	10-52305-1
S6LN-28	10-51369-43	10-51295-27	10-52936	10-52305-1	10-52305-1
S6LN-29	10-51369-44	10-51295-27	10-52936	10-52305-1	10-52305-1
S6LN-30	10-51369-45	10-51295-27	10-52936	10-52305-1	10-52305-1
S6LN-31	10-51369-46	10-51295-27	10-52936	10-52305-1	10-52305-1
S6LN-32	10-51369-47	10-51295-27	10-52936	10-52305-1	10-52305-1
S6LN-33	10-51369-48	10-51295-27	10-52936	10-52305-1	10-52305-1
S6LN-34	10-51369-49	10-51295-27	10-52936	10-52305-1	10-52305-1
S6LN-35	10-52290-19	10-52290-2	10-52936	10-52305-1	10-52305-1
S6LN-36	10-52290-20	10-52290-3	10-52936	10-52305-1	10-52305-1
S6LN-37	10-52290-21	10-52290-4	10-52936	10-52305-1	10-52305-1
S6LN-38	10-52290-22	10-52290-14	10-52936	10-52305-1	10-52305-1
S6LN-39	10-52290-23	10-52290-15	10-52936	10-52305-1	10-52305-1
S6LN-40	10-52290-24	10-52290-2	10-52936	10-52305-1	10-52305-1
S6LN-41	10-52290-25	10-52290-3	10-52936	10-52305-1	10-52305-1
S6LN-42	10-52290-26	10-52290-4	10-52936	10-52305-1	10-52305-1
S6LN-43	10-52290-27	10-52290-14	10-52936	10-52305-1	10-52305-1
S6LN-44	10-52290-28	10-52290-15	10-52936	10-52305-1	10-52305-1
S6LN-45	10-52290-29	10-52290-2	10-52936	10-52305-1	10-52305-1
S6LN-46	10-52290-30	10-52290-3	10-52936	10-52305-1	10-52305-1
S6LN-47	10-52290-31	10-52290-4	10-52936	10-52305-1	10-52305-1
S6LN-48	10-52290-32	10-52290-14	10-52936	10-52305-1	10-52305-1
S6LN-49	10-52290-33	10-52290-15	10-52936	10-52305-1	10-52305-1
S6LN-50	10-52290-34	10-52290-2	10-52936	10-52305-1	10-52305-1
S6LN-51	10-52290-35	10-52290-3	10-52936	10-52305-1	10-52305-1
S6LN-52	10-52290-36	10-52290-4	10-52936	10-52305-1	10-52305-1
S6LN-53	10-52290-37	10-52290-14	10-52936	10-52305-1	10-52305-1
S6LN-54	10-52290-38	10-52290-15	10-52936	10-52305-1	10-52305-1
S6LN-55	10-52290-39	10-52290-2	10-52936	10-52305-1	10-52305-1
S6LN-56	10-52290-40	10-52290-3	10-52936	10-52305-1	10-52305-1
S6LN-57	10-52290-41	10-52290-4	10-52936	10-52305-1	10-52305-1
S6LN-58	10-52290-42	10-52290-14	10-52936	10-52305-1	10-52305-1
S6LN-59	10-52290-43	10-52290-15	10-52936	10-52305-1	10-52305-1
S6LN-60	10-52290-44	10-52290-2	10-52936	10-52305-1	10-52305-1
S6LN-61	10-52290-45	10-52290-3	10-52936	10-52305-1	10-52305-1
S6LN-62	10-52290-46	10-52290-4	10-52936	10-52305-1	10-52305-1
S6LN-63	10-52290-47	10-52290-14	10-52936	10-52305-1	10-52305-1
S6LN-64	10-52290-48	10-52290-15	10-52936	10-52305-1	10-52305-1
S6LN-65	10-52290-49	10-52290-2	10-52936	10-52305-1	10-52305-1
S6LN-66	10-52290-50	10-52290-3	10-52936	10-52305-1	10-52305-1
S6LN-67	10-52290-51	10-52290-4	10-52936	10-52305-1	10-52305-1
S6LN-68	10-52290-52	10-52290-14	10-52936	10-52305-1	10-52305-1
S6LN-69	10-52290-53	10-52290-15	10-52936	10-52305-1	10-52305-1
S6LN-70	10-52290-54	10-52290-2	10-52936	10-52305-1	10-52305-1
S6LN-71	10-52290-55	10-52290-3	10-52936	10-52305-1	10-52305-1
S6LN-72	10-52290-56	10-52290-4	10-52936	10-52305-1	10-52305-1
S6LN-73	10-52290-57	10-52290-14	10-52936	10-52305-1	10-52305-1
S6LN-74	10-52290-58	10-52290-15	10-52936	10-52305-1	10-52305-1
S6LN-75	10-52290-59	10-52290-2	10-52936	10-52305-1	10-52305-1
S6LN-76	10-52290-60	10-52290-3	10-52936	10-52305-1	10-52305-1
S6LN-77	10-52290-61	10-52290-4	10-52936	10-52305-1	10-52305-1
S6LN-78	10-52290-62	10-52290-14	10-52936	10-52305-1	10-52305-1
S6LN-79	10-52290-63	10-52290-15	10-52936	10-52305-1	10-52305-1
S6LN-80	10-52290-64	10-52290-2	10-52936	10-52305-1	10-52305-1
S6LN-81	10-52290-65	10-52290-3	10-52936	10-52305-1	10-52305-1
S6LN-82	10-52290-66	10-52290-4	10-52936	10-52305-1	10-52305-1
S6LN-83	10-52290-67	10-52290-14	10-52936	10-52305-1	10-52305-1
S6LN-84	10-52290-68	10-52290-15	10-52936	10-52305-1	10-52305-1
S6LN-85	10-52290-69	10-52290-2	10-52936	10-52305-1	10-52305-1
S6LN-86	10-52290-70	10-52290-3	10-52936	10-52305-1	10-52305-1
S6LN-87	10-52290-71	10-52290-4	10-52936	10-52305-1	10-52305-1
S6LN-88	10-52290-72	10-52290-14	10-52936	10-52305-1	10-52305-1
S6LN-89	10-52290-73	10-52290-15	10-52936	10-52305-1	10-52305-1
S6LN-90	10-52290-74	10-52290-2	10-52936	10-52305-1	10-52305-1
S6LN-91	10-52290-75	10-52290-3	10-52936	10-52305-1	10-52305-1
S6LN-92	10-52290-76	10-52290-4	10-52936	10-52305-1	10-52305-1
S6LN-93	10-52290-77	10-52290-14	10-52936	10-52305-1	10-52305-1
S6LN-94	10-52290-78	10-52290-15	10-52936	10-52305-1	10-52305-1
S6LN-95	10-52290-79	10-52290-2	10-52936	10-52305-1	10-52305-1
S6LN-96	10-52290-80	10-52290-3	10-52936	10-52305-1	10-52305-1
S6LN-97	10-52290-81	10-52290-4	10-52936	10-52305-1	10-52305-1
S6LN-98	10-52290-82	10-52290-14	10-52936	10-52305-1	10-52305-1
S6LN-99	10-52290-83	10-52290-15	10-52936	10-52305-1	10-52305-1
S6LN-100	10-52290-84	10-52290-2	10-52936	10-52305-1	10-52305-1

All items on this page are Price Code 245 unless otherwise noted

Price and availability subject to change without notice. Univair's Toll Free Sales: 1-888-433-5433

ENGINE PARTS and ACCESSORIES

Bendix Magneto Repair Kits By Aero Accessories FAA/PMA Approved



Bendix Magneto Repair Kit
Part NumberAB-485-R



Bendix Magneto Deluxe Repair Kit
Part NumberAB-485-D

(Major Components Illustrated) additional parts included.

Aero Accessories Inc. TCM (Bendix) Series Magnetos Kit Application Guide

Magneto replacement parts manufactured and sold by Aero Accessories, Inc. are made to specifications dictated by Federal Aviation Administration parts manufacturing approvals. They are highest quality direct replacement parts, approved for installation and use on certified aircraft. Most Aero Accessories, Inc. part numbers include the part number of the original manufacturer ensuring an easy determination of replacement applicability. Always refer to the parts and service manual of the original equipment manufacturer, or to Aircraft Type Certificate Data Sheets or other FAA-Approved data to determine eligibility of a part or component for use in any application.

- (1) Contents of the Repair Kit and the Deluxe Repair Kit are listed to the right.
- (2) The Component Part Kits contain installation hardware.
- (3) The Repair Kit and Deluxe Repair Kit for the Bendix -200, -201 and -202 Series Magnetos contain two sets of Contact Assy. Kits.

- Repair Kit**
- 1-Contact Assy. Kit (3)
 - 1-Capacitor
 - 2-Bearings
 - 1-Oil Seal
 - 1-Oil Slinger
 - 3-Woodruff Keys
 - 1-Cotter Pin
 - 1-Cam Screw
 - 1-Felt Washer
 - 1-Felt Strip
 - 1-Snap Ring
 - 1-Carbon Brush

- Deluxe Repair Kit**
- 1-Contact Assy. Kit (3)
 - 1-Coil Kit
 - 1-Distributor Block Kit
 - 1-Gear Kit
 - 1-Capacitor
 - 2-Bearings
 - 1-Oil Seal
 - 1-Oil Slinger
 - 3-Woodruff Keys
 - 1-Cotter Pin
 - 1-Cam Screw

Aero Accessories, Inc. Kit Application Data TCM (Bendix) S-20 and S-21 Series Magnetos

MAGNETO Part Number	MAGNETO Type	REPAIR KIT Part Number	DELUXE REPAIR KIT Part Number
10-51360-1	S4R(L)N-20, -21	AB-473-R	AB-473-D
10-51360-3			
10-51360-4			
10-51360-6			
10-51360-8			
10-51360-10	S4R(L)N-20, -21	AB-474-R	AB-474-D
10-51360-11			
10-51360-12			
10-51360-25			
10-51360-26	S4R(L)N-20, -21	AB-473-R	AB-473-D
10-51360-27			
10-51360-28			
10-51360-29	S4R(L)N-20, -21	AB-474-R	AB-474-D
10-51360-30			
10-51360-31	S4R(L)N-20, -21	AB-473-R	AB-473-D
10-51360-33	S4R(L)N-20, -21	AB-474-R	AB-474-D
10-51360-37			
10-51360-40			
10-51360-41			
10-51360-45	S4LN-21	AB-485-R	AB-485-D
10-51360-46	S4R(L)N-20, -21	AB-474-R	AB-474-D
10-51360-47	S4LN-21	AB-485-R	AB-485-D
10-51360-48	S4R(L)N-20, -21	AB-484-R	AB-484-D
10-51360-54	S4R(L)N-20, -21	AB-474-R	AB-474-D
10-51360-55	S4LN-21	AB-485-R	AB-485-D
10-51360-58			

Note:
Repair Kit - Minor repair such as a 500 hour inspection.
Deluxe Repair Kit - Major repair such as a magneto overhaul.*

* Some parts that may need replacing during magneto overhaul are not included in this kit. Refer to the TCM (Bendix) Master Service Manual for parts not included in this Deluxe Repair Kit.

Note: The component part kits contain installation hardware.

Aero Accessories, Inc. Kit Application Data TCM (Bendix) S-24 and S-25 Series Magnetos

MAGNETO Part Number	MAGNETO Type	REPAIR KIT Part Number	DELUXE REPAIR KIT Part Number
10-79020-5	S6R(L)N-24, -25	AB-674-R	AB-674-D
10-79020-6			
10-79020-8			
10-79020-10			
10-79020-11	S6LN-25	AB-685-R	AB-685-D
10-79020-13	S6R(L)N-24, -25	AB-674-R	AB-674-D
10-79020-14			
10-79020-16			
10-79020-17	S6LN-25	AB-685-R	AB-685-D
10-79020-18			
10-79020-118			
10-79020-19	S6RN-25	AB-684-R	AB-684-D
10-79020-119			

ENGINE PARTS and ACCESSORIES

Aero Accessories, Inc. Kit Application Data TCM (Bendix) S-20 and S-21 Series Magnetos

MAGNETO Part Number	MAGNETO Type	REPAIR KIT Part Number	DELUXE REPAIR KIT Part Number
10-51360-1	Up to SN 238468 S6R(L)N	AB-673-R	AB-673-D
10-51365-1	SN 238469 and up S6R(L)N	AB-674-R	AB-674-D
10-51365-2	S6R(L)N-20, -21	AB-673-R	AB-673-D
10-51365-5			
10-51365-7			
10-51365-9	S6R(L)N-20, -21	AB-674-R	AB-674-D
10-51365-13	S6R(L)N-20, -21	AB-673-R	AB-673-D
10-51365-14	S6R(L)N-20, -21	AB-674-R	AB-674-D
10-51365-15			
10-51365-16			
10-51365-17			
10-51365-20			
10-51365-25			
10-51365-26			
10-51365-27			
10-51365-28			
10-51365-29			
10-51365-30			
10-51365-31			
10-51365-32			
10-51365-33			
10-51365-34			
10-51365-35			
10-51365-39			
10-51365-40	S6R(L)N-20, -21	AB-673-R	AB-673-D
10-51365-41			
10-51365-42	S6R(L)N-20, -21	AB-674-R	AB-674-D
10-51365-43			
10-51365-44			
10-51365-45			
10-51365-46			
10-51365-47			
10-51365-48	S6R(L)N-20, -21	AB-673-R	AB-673-D
10-51365-53	S6R(L)N-20, -21	AB-674-R	AB-674-D
10-51365-54			
10-51365-57	S6LN-20, -21	AB-685-R	AB-685-D

Aero Accessories, Inc. Kit Application Data TCM (Bendix) S-200 Series Magnetos

MAGNETO Part Number	MAGNETO Type	REPAIR KIT Part Number	DELUXE REPAIR KIT Part Number
10-163005-1	S4R(L)N-200*	AB-200445-R	AB-200445-D
10-163005-2			
10-163005-3			
10-163005-4			
10-163005-5			
10-163005-7			
10-163005-10			
10-163005-11			
10-163015-1	S4R(L)N-201*	AB-200445-R	AB-200445-D
10-163015-2			
10-163015-3			
10-163015-4			

TCM (Bendix) S-200 Kit Application Data (continued)

MAGNETO Part Number	MAGNETO Type	REPAIR KIT Part Number	DELUXE REPAIR KIT Part Number
10-163045-1	S4LN-204	AB-200485-R	AB-200485-D
10-163045-2	S4RN-204	AB-200484-R	AB-200484-D
10-163045-3	S4LN-204	AB-200485-R	AB-200485-D
10-163045-4	S4RN-204	AB-200484-R	AB-200484-D
10-163045-6	S4LN-204	AB-200485-R	AB-200485-D
10-163045-7	S4RN-204	AB-200484-R	AB-200484-D
10-163055-1	S4RN-205	AB-200484-R	AB-200484-D
10-163055-2	S4RN-205	AB-200485-R	AB-200484-D
10-163010-1	S6R(L)N-200*	AB-200645-R	AB-200645-D
10-163010-2			
10-163010-3			
10-163010-4			
10-163010-5			
10-163010-6			
10-163010-7			
10-163010-8			
10-163010-9			
10-163010-10			
10-163010-11			
10-163010-15			
10-163010-17			
10-163020-1	S6R(L)N-201*	AB-200645-R	AB-200645-D
10-163020-2			
10-163020-3			
10-163020-4			
10-163030-1	S6R(L)N-202*	AB-200645-R	AB-200645-D
10-163030-4			
10-163050-1	S6LN-204	AB-200685-R	AB-200685-D
10-163050-2			
10-163050-3			
10-163050-5			
10-163050-6	S6RN-204	AB-200684-R	AB-200684-D
10-163050-7			
10-163050-8			
10-163050-9	S6LN-204	AB-200685-R	AB-200685-D
10-163060-1	S6RN-205	AB-200684-R	AB-200684-D
10-163060-2	S6LN-205	AB-200685-R	AB-200685-D
10-163070-1	S6LN-206	AB-200685-R	AB-200685-D
10-163070-3			

Need a part that you can't find?

Give us a call at:

1 (888) 433-5433

Fax: 1 (800) 457-7811

e-mail: info@univair.com

Web site: www.univair.com



All items on this page are Price Code 245 unless otherwise noted

Price and availability subject to change without notice. Univair's Toll Free Sales: 1-888-433-5433

ENGINE PARTS and ACCESSORIES

FAA/PMA Approved Replacement Parts for Bendix Type Magnetos

Description	Part No.
Screw	AB-102083
Washer	AB-14268
Screw	AB-157158
Brush	AB-160844
Felt	AB-163374
Bearing	AB-2-202
O Ring	AB-349263
Capacitor Kit	AB-349276
Fish Paper	AB-349326
Washer (Steel)	AB-349511
Screw	AB-349652
Bearing	AB-353056
Bearing	AB-353060
Coil Kit	AB-357164-1
Coil Kit	AB-357165-1
Contact Kit	AB-357173
Contact Kit	AB-357174
Capacitor	AB-357281
Distributor Block Kit	AB-357424
Distributor Block Kit	AB-357426
Gear Kit	AB-357584
Gear Kit	AB-357586
Oil Seal	AB-357592
Screw	AB-35935-6
Screw	AB-35936-7
Screw	AB-35937-8
Fish Paper	AB-382568
Contact Kit	AB-382584
Contact Kit	AB-382585
Contact Kit	AB-382622
Capacitor	AB-382681
Washer	AB-382788
Screw	AB-382789
Capacitor	AB-382807
Screw	AB-382871
Screw	AB-382881
Nut	AB-382936
Screw	AB-382959
Bearing	AB-382971
Coil	AB-391088-1
Distributor Block Lub. (8 Oz.)	AB-391200
Screw	AB-391213
Washer, Nylon	AB-391309
Spring	AB-50737
Felt	AB-50752
Clamp, Coil	AB-50765
Capacitor	AB-51676
Slinger, Oil	AB-51678
Washer	AB-53397
Washer	AB-55501
Bearing Grease (2 oz.)	AB-56172
Bearing Grease (16 oz.)	AB-56172-1
Washer, Steel	AB-606505
Gear Kit	AB-682014
Bearing	AB-81806
Lubricant, Felt	AB-86527
Cotter Pin	AB-90751-18
Cotter Pin	AB-90751-19
Woodruff Key	AB-90788-5
Snap Ring	AB-92815-37
Snap Ring	AB-92815-62

FAA/PMA Approved Replacement Parts for Slick-Type Magnetos

Woodruff Key	AM2536
Cotter Pin	AM2540
Bearing	AM3006
Screw	AM3014
Screw	AM3014-1
Screw	AM3021
Seal	AM3062
Contact Assy. Kit	*AM3081
Washer, Contact	A13081-1
Screw, Contact	A13081-2

FAA/PMA Approved Replacement Parts for Slick-Type Magnetos

Lube, Contact	A13081-8
Capacitor Assy	**AM3183
Nut, Capacitor	AM3183-1
Washer, Capacitor	AM3183-2
Brush	AM3215
Spring	AM3217
Bearing and Cap Assy	AM3485
Cam	AM3611

*Kit includes: A13081, A13081-1, -2 & AM3611
**Includes: AM3183, AM3182-1, & -2

PC 245

Eisemann LA Series Magneto Handbook and Instructions

This manual contains service and overhaul information, exploded views and parts listings.



Part NumberE-LAHB

PC 255

Gascolator for Larger 1/2" Fuel Lines

1/2" Gascolator with Metal Bowl and Quick Drain.



Gascolator for use with 1/2" fuel lines similar to U14330-002 except with large head for 1/2" fuel system.

Complete 1/2" Gascolator1702*
1/2" Gascolator Head only1700*
1/2" Gascolator Screen only1701

*Requires Field Approval or STC call out.

PC 150

No matter what you need for your classic aircraft, Univair is prepared to help keep you flying! Our knowledgeable salespeople are waiting to answer your questions and to fill your order accurately and quickly. Call them at:

1 (888) 433-5433

INDUCTOR Magneto Synchronizers



Space Age Electronics

This INDUCTOR Magneto Timing Device is a new concept utilizing the latest digital integrated circuitry, thus eliminating the need for the battery draining mechanical buzzer found in most of the older magneto timing lights. The timing indicators are light emitting diodes (L.E.D.s) rather than the commonly used incandescent bulbs, further extending battery life. Since the device measures change of inductance in the magneto coil, it will not give a false reading should the clip leads pop off or become shorted. The INDUCTOR can also be used as a relay coil tester to determine whether the coil is functioning.

Size

One of the INDUCTOR's most convenient features is its compact size. It measures 3/4 by 3 by 5 inches and is packaged in an anodized aluminum case that will neither melt nor break. It fits into the mechanic's tool box or shirt pocket and weighs only nine ounces.

Power

The INDUCTOR is powered by a 9-volt Duracell® battery. With the inherent low power drain of the device and prudent use of the on-off switch, the battery should function for as long as its shelf life. If the L.E.D.s fail to toggle when the magneto points open or close, it is an indication that the battery needs changing.

Single Magneto Synchronizer Model.....AA001
Dual Magneto Synchronizer Model.....AA002
Single Magneto Synchronizer with Tweeter*...AA003
Dual Magneto Synchronizer with Tweeter *...AA004

* These Synchronizer models with a tweeter, provide audio as well as visual indication of operation.

PC 699

ENGINE PARTS and ACCESSORIES



Call (303-375-8882) or write Univair for price and availability of the Oil Filter Assembly and Engine Adapter.



The only FAA Approved pure lubricant.



- Control damaging rust and corrosion in your engine.
- Provide positive lubrication and prevent dry engine starts.
- Keep new and rebuilt engines dimensionally correct.
- Control critical engine temperatures.
- Prevent unnecessary maintenance expense caused by premature wear.
- Restore performance to engines with accumulated hours.

Single 12 oz. canAVBLEND-1
 Pack of 4-12oz. cansAVBLEND-4

Oil Filter Application Chart

Model	Engine Model	Spin-On Filter	Flareless
Aero Commander Aircraft Single Engine			
440-50	0-20	CF2870-1	CF111-0
440-50	0-30	CF2870-1	CF111-0
440-50	0-50	CF2870-1	CF111-0
Beech Single Engine Models			
Baron			
175A-175A-175	0-50	CF2870-1	CF111-0
175A-175A-175	0-75	CF2870-1	CF111-0
175A-175A-175	100-120	CF2870-1	CF111-0
Cessna			
175A-175A-175	0-50	CF2870-1	CF111-0
With Stud Without Stud			
175A-175A-175	0-50	CF2870-1	CF111-0
175A-175A-175	0-75	CF2870-1	CF111-0
175A-175A-175	0-100	CF2870-1	CF111-0
175A-175A-175	0-120	CF2870-1	CF111-0
175A-175A-175	0-150	CF2870-1	CF111-0
Cessna Single Engine Models			
175	0-20	CF2870-1	CF111-0
175	0-20	CF2870-1	CF111-0
175	0-30	CF2870-1	CF111-0
175	0-40	CF2870-1	CF111-0
175	0-50	CF2870-1	CF111-0
175	0-75	CF2870-1	CF111-0
175	0-100	CF2870-1	CF111-0
175	0-120	CF2870-1	CF111-0
175	0-150	CF2870-1	CF111-0
175	0-200	CF2870-1	CF111-0
175	0-250	CF2870-1	CF111-0
175	0-300	CF2870-1	CF111-0
175	0-350	CF2870-1	CF111-0
175	0-400	CF2870-1	CF111-0
175	0-450	CF2870-1	CF111-0
175	0-500	CF2870-1	CF111-0
175	0-550	CF2870-1	CF111-0
175	0-600	CF2870-1	CF111-0
175	0-650	CF2870-1	CF111-0
175	0-700	CF2870-1	CF111-0
175	0-750	CF2870-1	CF111-0
175	0-800	CF2870-1	CF111-0
175	0-850	CF2870-1	CF111-0
175	0-900	CF2870-1	CF111-0
175	0-950	CF2870-1	CF111-0
175	1-000	CF2870-1	CF111-0
175	1-050	CF2870-1	CF111-0
175	1-100	CF2870-1	CF111-0
175	1-150	CF2870-1	CF111-0
175	1-200	CF2870-1	CF111-0
175	1-250	CF2870-1	CF111-0
175	1-300	CF2870-1	CF111-0
175	1-350	CF2870-1	CF111-0
175	1-400	CF2870-1	CF111-0
175	1-450	CF2870-1	CF111-0
175	1-500	CF2870-1	CF111-0
175	1-550	CF2870-1	CF111-0
175	1-600	CF2870-1	CF111-0
175	1-650	CF2870-1	CF111-0
175	1-700	CF2870-1	CF111-0
175	1-750	CF2870-1	CF111-0
175	1-800	CF2870-1	CF111-0
175	1-850	CF2870-1	CF111-0
175	1-900	CF2870-1	CF111-0
175	1-950	CF2870-1	CF111-0
175	2-000	CF2870-1	CF111-0
175	2-050	CF2870-1	CF111-0
175	2-100	CF2870-1	CF111-0
175	2-150	CF2870-1	CF111-0
175	2-200	CF2870-1	CF111-0
175	2-250	CF2870-1	CF111-0
175	2-300	CF2870-1	CF111-0
175	2-350	CF2870-1	CF111-0
175	2-400	CF2870-1	CF111-0
175	2-450	CF2870-1	CF111-0
175	2-500	CF2870-1	CF111-0
175	2-550	CF2870-1	CF111-0
175	2-600	CF2870-1	CF111-0
175	2-650	CF2870-1	CF111-0
175	2-700	CF2870-1	CF111-0
175	2-750	CF2870-1	CF111-0
175	2-800	CF2870-1	CF111-0
175	2-850	CF2870-1	CF111-0
175	2-900	CF2870-1	CF111-0
175	2-950	CF2870-1	CF111-0
175	3-000	CF2870-1	CF111-0
175	3-050	CF2870-1	CF111-0
175	3-100	CF2870-1	CF111-0
175	3-150	CF2870-1	CF111-0
175	3-200	CF2870-1	CF111-0
175	3-250	CF2870-1	CF111-0
175	3-300	CF2870-1	CF111-0
175	3-350	CF2870-1	CF111-0
175	3-400	CF2870-1	CF111-0
175	3-450	CF2870-1	CF111-0
175	3-500	CF2870-1	CF111-0
175	3-550	CF2870-1	CF111-0
175	3-600	CF2870-1	CF111-0
175	3-650	CF2870-1	CF111-0
175	3-700	CF2870-1	CF111-0
175	3-750	CF2870-1	CF111-0
175	3-800	CF2870-1	CF111-0
175	3-850	CF2870-1	CF111-0
175	3-900	CF2870-1	CF111-0
175	3-950	CF2870-1	CF111-0
175	4-000	CF2870-1	CF111-0
175	4-050	CF2870-1	CF111-0
175	4-100	CF2870-1	CF111-0
175	4-150	CF2870-1	CF111-0
175	4-200	CF2870-1	CF111-0
175	4-250	CF2870-1	CF111-0
175	4-300	CF2870-1	CF111-0
175	4-350	CF2870-1	CF111-0
175	4-400	CF2870-1	CF111-0
175	4-450	CF2870-1	CF111-0
175	4-500	CF2870-1	CF111-0
175	4-550	CF2870-1	CF111-0
175	4-600	CF2870-1	CF111-0
175	4-650	CF2870-1	CF111-0
175	4-700	CF2870-1	CF111-0
175	4-750	CF2870-1	CF111-0
175	4-800	CF2870-1	CF111-0
175	4-850	CF2870-1	CF111-0
175	4-900	CF2870-1	CF111-0
175	4-950	CF2870-1	CF111-0
175	5-000	CF2870-1	CF111-0
175	5-050	CF2870-1	CF111-0
175	5-100	CF2870-1	CF111-0
175	5-150	CF2870-1	CF111-0
175	5-200	CF2870-1	CF111-0
175	5-250	CF2870-1	CF111-0
175	5-300	CF2870-1	CF111-0
175	5-350	CF2870-1	CF111-0
175	5-400	CF2870-1	CF111-0
175	5-450	CF2870-1	CF111-0
175	5-500	CF2870-1	CF111-0
175	5-550	CF2870-1	CF111-0
175	5-600	CF2870-1	CF111-0
175	5-650	CF2870-1	CF111-0
175	5-700	CF2870-1	CF111-0
175	5-750	CF2870-1	CF111-0
175	5-800	CF2870-1	CF111-0
175	5-850	CF2870-1	CF111-0
175	5-900	CF2870-1	CF111-0
175	5-950	CF2870-1	CF111-0
175	6-000	CF2870-1	CF111-0
175	6-050	CF2870-1	CF111-0
175	6-100	CF2870-1	CF111-0
175	6-150	CF2870-1	CF111-0
175	6-200	CF2870-1	CF111-0
175	6-250	CF2870-1	CF111-0
175	6-300	CF2870-1	CF111-0
175	6-350	CF2870-1	CF111-0
175	6-400	CF2870-1	CF111-0
175	6-450	CF2870-1	CF111-0
175	6-500	CF2870-1	CF111-0
175	6-550	CF2870-1	CF111-0
175	6-600	CF2870-1	CF111-0
175	6-650	CF2870-1	CF111-0
175	6-700	CF2870-1	CF111-0
175	6-750	CF2870-1	CF111-0
175	6-800	CF2870-1	CF111-0
175	6-850	CF2870-1	CF111-0
175	6-900	CF2870-1	CF111-0
175	6-950	CF2870-1	CF111-0
175	7-000	CF2870-1	CF111-0
175	7-050	CF2870-1	CF111-0
175	7-100	CF2870-1	CF111-0
175	7-150	CF2870-1	CF111-0
175	7-200	CF2870-1	CF111-0
175	7-250	CF2870-1	CF111-0
175	7-300	CF2870-1	CF111-0
175	7-350	CF2870-1	CF111-0
175	7-400	CF2870-1	CF111-0
175	7-450	CF2870-1	CF111-0
175	7-500	CF2870-1	CF111-0
175	7-550	CF2870-1	CF111-0
175	7-600	CF2870-1	CF111-0
175	7-650	CF2870-1	CF111-0
175	7-700	CF2870-1	CF111-0
175	7-750	CF2870-1	CF111-0
175	7-800	CF2870-1	CF111-0
175	7-850	CF2870-1	CF111-0
175	7-900	CF2870-1	CF111-0
175	7-950	CF2870-1	CF111-0
175	8-000	CF2870-1	CF111-0
175	8-050	CF2870-1	CF111-0
175	8-100	CF2870-1	CF111-0
175	8-150	CF2870-1	CF111-0
175	8-200	CF2870-1	CF111-0
175	8-250	CF2870-1	CF111-0
175	8-300	CF2870-1	CF111-0
175	8-350	CF2870-1	CF111-0
175	8-400	CF2870-1	CF111-0
175	8-450	CF2870-1	CF111-0
175	8-500	CF2870-1	CF111-0
175	8-550	CF2870-1	CF111-0
175	8-600	CF2870-1	CF111-0
175	8-650	CF2870-1	CF111-0
175	8-700	CF2870-1	CF111-0
175	8-750	CF2870-1	CF111-0
175	8-800	CF2870-1	CF111-0
175	8-850	CF2870-1	CF111-0
175	8-900	CF2870-1	CF111-0
175	8-950	CF2870-1	CF111-0
175	9-000	CF2870-1	CF111-0
175	9-050	CF2870-1	CF111-0
175	9-100	CF2870-1	CF111-0
175	9-150	CF2870-1	CF111-0
175	9-200	CF2870-1	CF111-0
175	9-250	CF2870-1	CF111-0
175	9-300	CF2870-1	CF111-0
175	9-350	CF2870-1	CF111-0
175	9-400	CF2870-1	CF111-0
175	9-450	CF2870-1	CF111-0
175	9-500	CF2870-1	CF111-0
175	9-550	CF2870-1	CF111-0
175	9-600	CF2870-1	CF111-0
175	9-650	CF2870-1	CF111-0
175	9-700	CF2870-1	CF111-0
175	9-750	CF2870-1	CF111-0
175	9-800	CF2870-1	CF111-0
175	9-850	CF2870-1	CF111-0
175	9-900	CF2870-1	CF111-0
175	9-950	CF2870-1	CF111-0
175	10-000	CF2870-1	CF111-0
175	10-050	CF2870-1	CF111-0

ENGINE PARTS and ACCESSORIES

Auburn and Champion Spark Plug Cross Reference

- Massive electrode
- Shielded unless otherwise noted
- U.S. aircraft and engines

Most generally used spark plugs are shown in **BOLD TYPE**. Spark plug listing is taken from FAA approved data.

If you require a spark plug that is **NOT LISTED**, please call Univair at 1 (888) 433-5433 for price and availability.



Aircraft	Number of Spark Plugs per Engine	Champion Spark Plugs		AC & Auburn Spark Plugs	
		3/4 in. x 20	5/8 in. x 24	3/4 in. x 20	5/8 in. x 24
BERGUNA / CHAMPION / DECAHELON / SCOUT					
7AC, S7AC					ASB
Continental A-65 (65 hp)	8	RHM40E	REM40E	ESR88	SR88
7DC, S7DC			REM37BY		ASB
Continental C-85-8 (85 hp)	8	RHM40E	REM40E	ESR88	SR88
S7CCM, 7EC, S7EC, 7FC, 7HC			REM37BY		ASB
Continental C-90-12 (90 hp)	8	RHM40E	REM40E	ESR88	SR88
7GA, 7HC		RHM40E	REM37BY	ESR88	SR88
Lycoming O-290 (138 hp)	8	RHM40E	REM40E	ESR87	SR87
7GCA, 7GCB, 7GCA, 7GCA, 7GCB, 7KC	8	RHM40E	REM40E	ESR88	SR88
Lycoming O-320-A (50 hp)		RHM40E	REM40E	ESR87	SR87
7ACA					
Parker 7A-170-B	4	RHR32E			
7ECA		RHM40E		ESR88	SR88
Lycoming O-235-C (108 hp)	8	RHM40E	REM40E	ESR87	SR87
7ECA		RHM40E			ASB
Continental O-200 (100 hp)	8	RHM40E	REM40E	ESR88	SR88
7ECA					
Lycoming O-235-B (118 hp)	8	RHM38E	REM38E	ESR86	SR86
7KCA-B			REM37BY		
Lycoming O-300 (150 hp)	8	RHM40E		ESR88	SR88
MO-320 (150 hp)		RHM40E	REM40E	ESR88	SR88
8KCA-B					
Lycoming O-300 (150 hp)		RHM40E		ESR88	SR88
Lycoming MO-320 (150 hp)	8	RHM40E	REM40E	ESR88	SR88
8GCB Super Scout		RHM40E	REM40E	ESR88	SR88
Lycoming O-360 (Series) (180 hp)	8	RHM38E	REM38E	ESR87	SR87
8KCA-B		RHM40E	REM38E		
Lycoming MO-360 (180 hp)	8	RHM38E	REM38E	ESR88	SR88
BELLANCA					
14-13 Series					
Parker 6A-150 (150 hp)	12		REJ38		
Parker 6A-150 (165 hp)			REJ38		ASB
14-19		RHM40E		ESR88	SR88
Lycoming O-435-A (190 hp)	12	RHM40E	REM40E	ESR87	SR87
14-19-A, 14-19-AA, 260B					
Continental O-470 (170 hp)	12	RHR32E			

* All plug is unshielded and has no resistor

ENGINE PARTS and ACCESSORIES

Auburn and Champion Spark Plug Cross Reference (continued)

- Massive electrode
- Shielded unless otherwise noted
- U.S. aircraft and engines

Most generally used spark plugs are shown in **BOLD TYPE**. Spark plug listing is taken from FAA approved data.

If you require a spark plug that is **NOT LISTED**, please call Univair at 1 (888) 433-5433 for price and availability.



Aircraft	NUMBER OF Spark Plugs per Engine	Champion Spark Plugs		AC & Auburn Spark Plugs No Longer Available	
		3/4 in. x 20	5/8 in. x 24	3/4 in. x 20	5/8 in. x 24
CESSNA					
120-140					AB8
Continental C-80 (85 hp)	8	REM40E	REM40E	JENR58	SR88
Continental C-90 (95 hp)			REM37BY		
150-A thru 150-M					AB8
Continental C-200-A (100 hp)	8	REM40E	REM40E	JENR58	SR88
			REM37BY		
152, F152					
Lycoming O-235-L (110 hp)	8	REM40E	REM40E		
		REM38E	REM38E		
			REM37BY	JENR50	SR86
170					AB8
Continental O-145 (145 hp)	12	REM40E	REM40E	JENR58	SR88
			REM37BY		
170-A, 170-B					AB8
Continental O-300 (145 hp)	12	REM40E	REM40E	JENR58	SR88
			REM37BY		
172-A thru 172-EE Skyhawk					AB8
Continental O-300 (145 hp)	12	REM40E	REM40E	JENR58	SR88
			REM37BY		
172-F thru 172-L Skyhawk					SR88
Lycoming O-320-E (150 hp)	8	REM40E	REM40E	JENR57	SR87
		REM40E	REM40E		
172-N, F172-N Skyhawk/100					SR88
Lycoming O-320-11AD (160 hp)	8	REM40E	REM40E	JENR58	SR88
		REM38E	REM38E	JENR57	SR87
172-P Skyhawk					SR88
Lycoming O-320-D7E (160 hp)	8	REM38E	REM38E	JENR57	SR87
		REM40E	REM40E		
P172 Powermate					SR87
Continental GO-300-E (175 hp)	12	REM40E	REM40E	JENR57	SR87
		REM38E	REM38E		
			REM37BY		
R172-K, FR172-K Hawk XP					SR86
Continental R-300-K (195 hp)	12	REM38E	REM38E	JENR56	SR86
		REM40E	REM40E	JENR58	SR88
172 RG "Cutlass RG"					SR87
Lycoming O-360-11AD (180 hp)	8	REM38E	REM38E	JENR57	SR87
		REM40E	REM40E		
175-A, 175-B, 175-C Skylark					SR87
Continental GO-330-A, -B, -D, -E (175 hp)	12	REM38E	REM38E	JENR57	SR87
			REM37BY		
175					
Franklin 6A-375 B (180 hp, Franklin conversion)	12	REM37E			
177 Cardinal					SR88
Lycoming O-320-E (170 hp)	8	REM40E	REM40E	JENR57	SR87
		REM40E	REM40E		
177-A, 177-B Cardinal					SR88
Lycoming O-360-A156D (180 hp)	8	REM38E	REM38E	JENR57	SR87
			REM37BY		
Cardinal RG					SR86
Lycoming O-360-A156D (200 hp)	8	REM38E	REM38E	JENR56	SR86
		REM40E	REM40E		
180					SR86
Continental O-470-A thru O-470-D (225 hp)	12	REM40E	REM40E	JENR57	SR87

All items on this page are Price Code 265 unless otherwise noted

Price and availability subject to change without notice. Univair's Toll Free Sales: 1-888-433-5433

ENGINE PARTS and ACCESSORIES

Auburn and Champion Spark Plug Cross Reference (continued)

- Massive electrode
- Shielded unless otherwise noted
- U.S. aircraft and engines

Most generally used spark plugs are shown in **BOLD TYPE**. Spark plug listing is taken from FAA approved data.

If you require a spark plug that is **NOT LISTED**, please call Univair at **1 (888) 433-5433** for price and availability.



Aircraft	Number of Spark Plugs per Engine	Champion Spark Plugs		AC & Auburn Spark Plugs No Longer Available	
		3/4 in. x 20	5/8 in. x 24	3/4 in. x 20	5/8 in. x 24
CESNA (continued)					
180-A thru 180-D		RHM40F		HSR88	SR88
Continental O-470-K, O-470-L (230 hp)	12	RHM40F	REM40E	HSR87	SR87
180-E, -F, -G, -H, -J		RHM32E		HSR88	SR88
Continental O-470-R, O-470-S (230 hp)	12	RHM40E	REM40E	HSR87	SR87
180-K					
Continental O-470-U (230 hp)	12	RHR32E			
TRU					
Continental O-470-T SN 53287 and up (230 hp)	12	RHR32E			
182-A, 182-B, 182-C, 182-D		REM40E		HSR88	SR88
Continental O-470-L (230 hp)	12	REM40E	REM40E	HSR87	SR87
182-E thru 182-P Skylane		REM40E		HSR88	SR88
Continental O-470-R, O-470-S (230 hp)	12	REM40E	REM40E	HSR87	SR87
182-Q, -R, 182-Q, -R Skylane					
Continental O-470-T (230 hp)	12	CHR32E			
R182, FR182 Skylane RG		REM40E	REM40E	HSR88	SR88
Continental O-540-130SD (230 hp)	12	REM40E	REM40E	HSR87	SR87
182					
Continental O-540-U, SN 60042 and up (230 hp)	12	RHR32E			
ERCOUPE SERIES					
Aircoupe - Ferry F1 and F1A					A83
Continental C-90-16 (195 hp)	8	RHM40E	REM40E	HSR88	SR88
Alou - A2 and A2A			RHM37BY		A88
Continental C-90-16 (195 hp)	8	RHM40E	REM40E	HSR88	SR88
Ercooupe 415-C, -D, -C/D, -E, -G			REM47BY		A89
Continental C-75, -S, -90, O-230, S1U conversion	8	RHM40E	REM40E	HSR88	SR88
Mooney M-10			REM47BY		A88
Continental C-90-16 (195 hp)	8	RHM40E	REM40E		SR88
			REM47BY		
LUSCOMBE					
8 Series				HSR88	A88
Continental C-65, C-57	8	RHM40E	REM40E		SR88
			RHM37BY		
PIPER					
Cub J-3, J-4, J-5, PA-11, PA-17					A88
Continental A-65, 67, 69 and C-65 (175 hp)	8	REM40E	REM40E	HSR88	SR88
J-3, J-4, PA-15			RHM37BY		A88
Continental O-440-165 (165 hp)	8	RHM40E	REM40E	HSR88	SR88
PA-12, PA-14, PA-16			RHM40E	HSR88	SR88
Continental O-320-115 (115 hp)	8	REM40E	REM40E	HSR87	SR87

ENGINE PARTS and ACCESSORIES

Auburn and Champion Spark Plug Cross Reference (continued)

- Massive electrode
- Shielded unless otherwise noted
- U.S. aircraft and engines

Most generally used spark plugs are shown in **BOLD TYPE**. Spark plug listing is taken from FAA approved data.

If you require a spark plug that is **NOT LISTED**, please call Univair at 1 (888) 433-5433 for price and availability.



Aircraft	Number of Spark Plugs per Engine	Champion Spark Plugs		AC & Auburn Spark Plugs No Longer Available	
		3/4 in. x 20	5/8 in. x 24	3/4 in. x 20	5/8 in. x 24
PIPER (continued):					
Super Cub PA-11H "95"		RIEM40E	REM40E	H5R88	SR88
Continental C-90-95 Hp 1	8	RIEM40E	REM40E	H5R88	SR88
PA-18 "105"		RIEM40E	REM40E	H5R88	SR88
Lycoming O-235-105 Hp 1	8	RIEM40E	REM40E	H5R87	SR87
PA-18 "125"		RIEM40E	REM40E	H5R88	SR88
Lycoming O-290-D 125 hp 1	8	RIEM40E	REM40E	H5R87	SR87
PA-18 "135"		RIEM40E	REM40E	H5R88	SR88
Lycoming O-290-D2 135 hp 1	8	RIEM40E	REM40E	H5R87	SR87
PA-18 "150"		RIEM40E	REM40E	H5R88	SR88
Lycoming O-320-A 150 hp 1	8	RIEM40E	REM40E	H5R87	SR87
Pacer PA-20 "115"		RIEM40E	REM40E	H5R88	SR88
Lycoming O-240-C 115 hp 1	8	RIEM40E	REM40E	H5R87	SR87
PA-20 "125"		RIEM40E	REM40E	H5R88	SR88
Lycoming O-290-D 125 hp 1	8	RIEM40E	REM40E	H5R87	SR87
PA-20 "135"		RIEM40E	REM40E	H5R88	SR88
Lycoming O-290-D2 135 hp 1	8	RIEM40E	REM40E	H5R87	SR87
Tri-Pacer PA-22 "135"		RIEM40E	REM40E	H5R88	SR88
Lycoming O-290-D2 135 hp 1	8	RIEM40E	REM40E	H5R87	SR87
PA-22 "150"		RIEM40E	REM40E	H5R88	SR88
Lycoming O-330-A 150 hp 1	8	RIEM40E	REM40E	H5R87	SR87
PA-22 "160"		RIEM40E	REM40E	H5R88	SR88
Lycoming O-320-B 160 hp 1	8	RIEM38E	REM38E	H5R87	SR87
Apache PA-23 "150"		RIEM40E	REM40E	H5R88	SR88
20 Lycoming O-320-A 150 hp 1	8	RIEM40E	REM40E	H5R87	SR87
PA-23 "160"		RIEM40E	REM40E	H5R88	SR88
20 Lycoming O-320-B 160 hp 1	8	RIEM38E	REM38E	H5R87	SR87
PA-23 "235"		RIEM40E	REM40E	H5R88	SR88
20 Lycoming O-540-B 135 hp 1	12	RIEM40E	REM40E	H5R88	SR88
Aztec PA-23 "250"		RIEM40E	REM40E	H5R88	SR88
20 Lycoming O-540-A 150 hp 1	12	RIEM38E	REM38E	H5R87	SR87
Aztec C, D, E, F PA-23 "250"		RIEM40E	REM40E	H5R88	SR88
20 Lycoming O-540-A 150 hp 1	12	RIEM38E	REM38E	H5R87	SR87
Aztec—Turbo-Blown		RIEM38E	REM38E	H5R88	SR88
20 Lycoming IO-540 1250 hp 1	12	RIEM38E	REM38E	H5R87	SR87
Aztec C, D, E, F PA-23 "250"		RIEM38E	REM38E	H5R88	SR88
20 Lycoming IO-540-C 1250 hp 1	12	RIEM38E	REM38E	H5R87	SR87
Continental PA-24 "180"		RIEM40E	REM40E	H5R88	SR88
Lycoming O-360-A 180 Hp 1	8	RIEM38E	REM38E	H5R87	SR87

All items on this page are Price Code 265 unless otherwise noted

Price and availability subject to change without notice. Univair's Toll Free Sales: 1-888-433-5433

ENGINE PARTS and ACCESSORIES

Auburn and Champion Spark Plug Cross Reference (continued)

- Massive electrode
- Shielded unless otherwise noted
- U.S. aircraft and engines

Most generally used spark plugs are shown in **BOLD TYPE**. Spark plug listing is taken from FAA approved data.

If you require a spark plug that is **NOT LISTED**, please call Univair at 1 (888) 433-5433 for price and availability.



Aircraft	Number of Spark Plugs per Engine	Champion Spark Plugs		Auburn Spark Plugs No Longer Available	
		3/4 in. x 20	5/8 in. x 24	3/4 in. x 20	5/8 in. x 24
PIPER (continued)					
PA-24 "250"		REM10E	REM14E	1SR86	SR86
Lycoming O-540 A, C, D, E (250 hp) ... 12		REM13E	REM13E		
PA-24 "260", PA-24 B and C					
Lycoming B-340-B, D, E (260 hp) ... 12		REM13E	REM13E	1SR86	SR86
PA-24 "260" Turbo					
Lycoming IO-540-RI35 (260 hp) ... 12		REM17E			
PA-24 "400"					
Lycoming IO-720 A (400 hp) ... 6		REM13E		1SR86	SR86
Pawnee PA-25 "150"		REM14E		1SR88	SR88
Lycoming H-300-A (150 hp) ... 8		REM10E	REM14E	1SR87	SR87
PA-25 "235"		REM10E			
Lycoming O-540 B (235 hp) ... 12		REM14E	REM14E	1SR88	SR88
PA-25 "260"		REM14E	REM14E	1SR88	SR88
Lycoming H-340 (260 hp) ... 12		REM13E	REM13E	1SR87	SR87
STINSON					
108 Series			REM138		
Franklin 6A-130 (130 hp) ... 12					A44*
108-5					
Franklin 6A-135-B (135 hp) ... 12		REM142E			
108 Series Stinson		REM14E			A88
Lycoming O-475 C (140 hp) ... 12		REM14E	REM14E	1SR88	SR88
STC conversion				1SR87	SR87
108 Series Stinson		REM14E		1SR88	SR88
Continental O-470-A (225 hp) STC conversion ... 12		REM14E	REM14E	1SR87	SR87
108-3					
Franklin 6A-150 C (150 hp) STC conversion ... 12					
108 Series Stinson		REM14E		1SR88	SR88
Lycoming O-367 A, A (180 hp) STC conversion ... 8		REM13E	REM13E	1SR87	SR87
108 Series Stinson		REM13E	REM13E	1SR86	SR86
Lycoming H-360-A (200 hp) STC conversion ... 8		REM13E	REM13E	1SR86	SR86
TAYLORCRAFT					
B Series					A38
Continental C-65 (65 hp) ... 8		REM14E	REM14E	1SR88	SR88
E-19		REM14E	REM17E		A38
Continental C-200 (100 hp) ... 8		REM14E	REM14E	1SR88	SR88
			REM17E		

*A44 plug is unshielded and has no resistor

ENGINE PARTS and ACCESSORIES

General Spark Plug Cross Reference

Auburn Spark Plugs	Champion Spark Plugs
14mm	
SA43*	REJ38
A44**	J43*
SR47P*	REL37W
18mm Fine Wire (Long Reach)	
181*	REB36W, REB36P
281*	RHB36P
291*	RHB36W
283*	RHB32
293*	RHB32W
286*	—
18mm Fine Wire (Short Reach)	
SR83P*	REM38P
HSR83P*	RHM38P
SR93*	REM38S
HSR93*	RHM38W
18mm Massive Electrode (Short Reach)	
A88*	M41E, M42E
S88*	EM42E
HS88*	RHM40E
SR88*	REM40E
HSR88*	RHM40E
SR87*	REM38E
HSR87*	RHM38E
SR86*	REM38E
HSR86*	RHM38E
18mm Massive Electrode (Long Reach)	
171*	REB37E, REB37N
271*	RHB37N, RHB37E, RHB38E
172*	REB87N
273*	RHB32N, RHB32E, RHB33E
175*	REB29N
275*	RHB29N, RHB29E

* Plug is no longer available from Univair.

** A44 plug is unshielded and has no resistor.

Miscellaneous Spark Plugs—While Supply Lasts!

AC Spark Plugs

LS87
LS86



Champion Spark Plug:

RHB36P
(Fine Wire)

REA37N



BG Spark Plug:

BG417

Champion Spark Plugs — Inside a Spark Plug

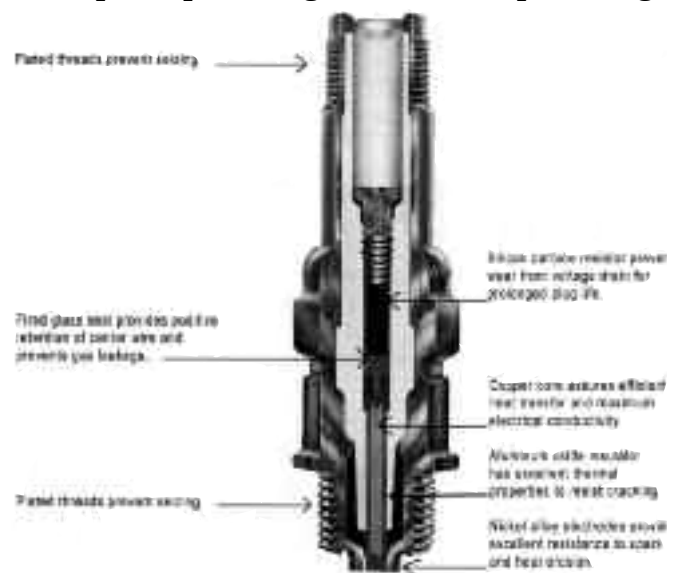

Advanced-engineered Champion aviation spark plugs are designed for the critical difference in performance, far beyond the ordinary. Champion aviation spark plugs stand up to high temperatures, pressures and lead deposits, with a performance second to none. When you're up in the air, count on quality Champion spark plugs.

The #1 Choice Worldwide - OEM for all U.S. Piston Engines

Champion spark plugs are a product of Champion Spark Plug Company's commitment to quality and advanced technology, a commitment that has made Champion spark plugs the #1 choice of engine manufacturers, maintenance technicians and pilots around the world.

FAA Aero Accessories

Centurion
Fuel Pump



FAA/PMA Approved Direct Replacement

Continental Engine	Aero Accessories	TCM	A/C Type
A-65, 8, 8F	AF-40585	40585	9051/9867
C-75, 12, 12F	AF-40695	40695	9076/4036
C-85, 8, 12	AF-40585	40585	9051/9867
C-90, 8, 8F, 12, 12F	AF-40695	40695	9076/4036
C-90-14F **	**	**	**
C-90, 16F *	AF-631391	631391	6861
0-200 *	AF-631391	631391	6861
A-75	AF-40585	40585	9051/9867
A-100	AF-40585	40585	9051/9867
C-125, 2	AF-40585	40585	9051/9867
C-145, 2, 2H	AF-40585	40585	9051/9867

* Uses camshaft P/N 626608 or supersedure to which P/N 630403 or supersedure Gear and Eccentric has been assembled. REFERENCE CONTINENTAL SERVICE BULLETIN M-76-15

** See aircraft and engine manual. This engine may use either AC part numbers 9867 or 9076. TCM part numbers 40585 or 40695. Aero Accessories part numbers AF-40585 or AF-40695.

PC 201

All items on this page are Price Code 265 unless otherwise noted

Price and availability subject to change without notice. Univair's Toll Free Sales: 1-888-433-5433

Airborne Pneumatic System Filters

Clean air is essential for satisfactory operation of gyros and other elements in a pneumatic system, and Airborne filters provide effective barriers to contaminants. In this way, they provide an extra margin of protection against air pump overheating or unreliable system operation.

It's important to remember, however, that the more efficient the filter, the dirtier it gets and the greater the need to replace it. (Both inline and inlet Airborne filters utilize 0.3-micron filtration elements). Accordingly, the recommended course is to choose Airborne filters for their efficiency and to maintain that efficiency with a regular filter element replacement program.

In this way, you'll reduce aircraft net operating cost by prolonging gyro life and instrument serviceability.

In-Line Filters for Pressure Systems

1J1 Series

Provides a limited level of inlet air contamination protection. Bulkhead fittings with beaded tube ports simplify mounting through firewalls and baffle plates.

Part Number1J1-3
 Filter replacement element Part NumberB3-5-1

1J4 Series

Insures a supply of clean air for all system components in pressure systems. Fabricated and sealed to prevent air loss or contamination. Replace entire filter assembly when change is needed.



Hose size	Overall Length	Part Number
1/2 X 1/2	5 3/4	1J4-4
5/8 X 5/8	6 3/4	1J4-6
5/8 X 5/8	5 1/2	1J4-7

Replacement Filter Elements



Used in 1J2 Series Inlet Filter, except 1J2-2 (interchangeable with Cessna part number C294501-0103)

Part Number.....D9-14-5

Used in 1J2-2 Inlet Filter Only

Part Number.....D9-14-3







Used in 1J7-1

Part Number.....D9-14-5



Valve filter, fits all Series 133 and 2H3 regulating valves

Airborne Air Filter Replacement Schedule

Replacement Chart	Vacuum systems	Pressure systems
Change every 100 hours or annually, whichever comes first.	 Vacuum regulator garter filter	 Inlet Filter Element
Change annually or every 500 hours, whichever comes first.	 Central air filter element	 Inline Filter

Filters for Pressure/Vacuum Systems

1J2 Series

For high-level air filtration, particularly in desert areas or dusty environments. Filter element is replaced simply by removing wing nut.



Filter Assembly Part Number.....1J2-1
 Filter replacement element Part Number.....D9-14-5

Filters for Vacuum Systems

1J7-1

Widely used for all vacuum gyro systems. Re-placement elements available. Unit features 3/8-inch beaded tubes for two-gyro installation.



Filter Assembly Part Number.....1J7-1
 Filter replacement element Part Number.....D9-18-1

1J7-2

Like 1J7-1 except for utilizing one single 3/8-inch beaded tube port.

Filter Assembly Part Number.....1J7-2
 Filter replacement element Part Number.....D9-18-1

1J10-1

Central gyro air filter. Replace entire filter assembly at the proper time.



Part Number1J10-1

Pressure Regulating Valves



These devices operate by discharging excess air to maintain steady system pressure. No filters are needed because the valves release excess air overboard. Pressure range is 2 to 7 PSI.

3/4 inch X 5/8 inch Hose2H30-6
 5/8 inch X 5/8 inch Hose2H30-9